

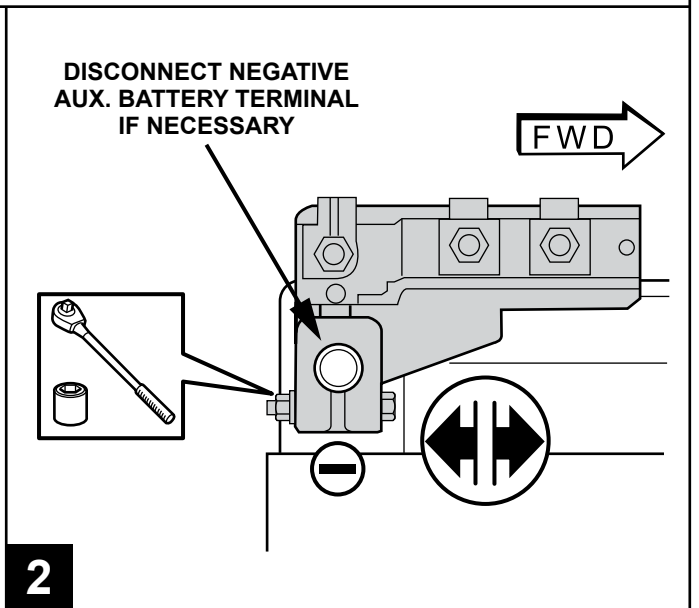

# RAM TELEMATICS

## RAM 1500 / RAM HEAVY DUTY

www.mopar.com

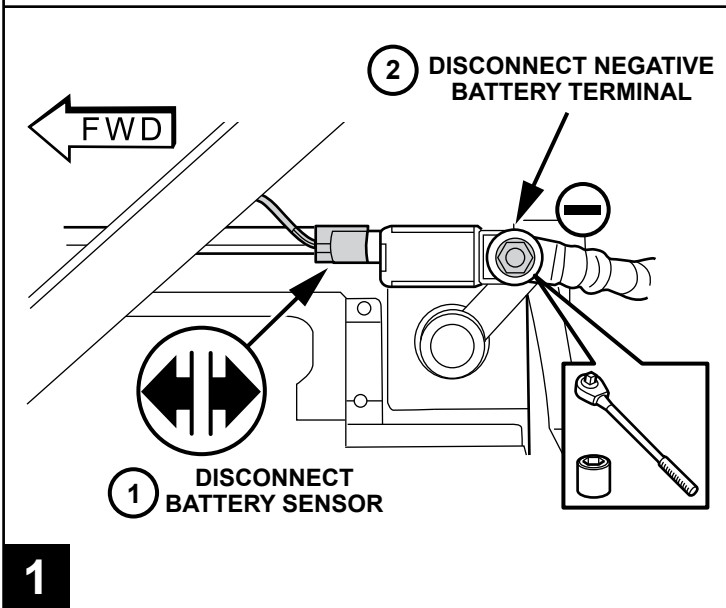
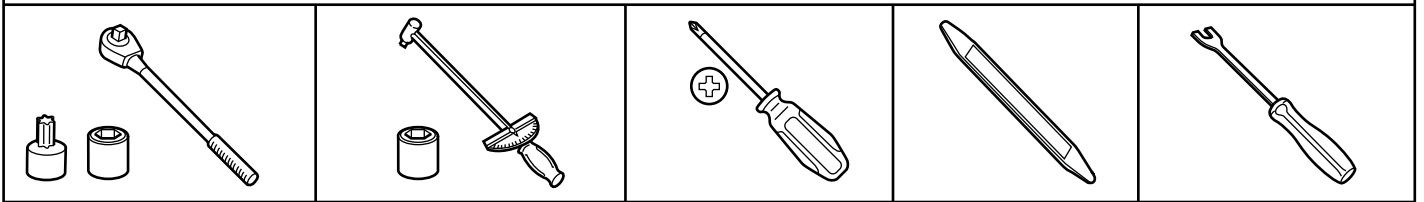
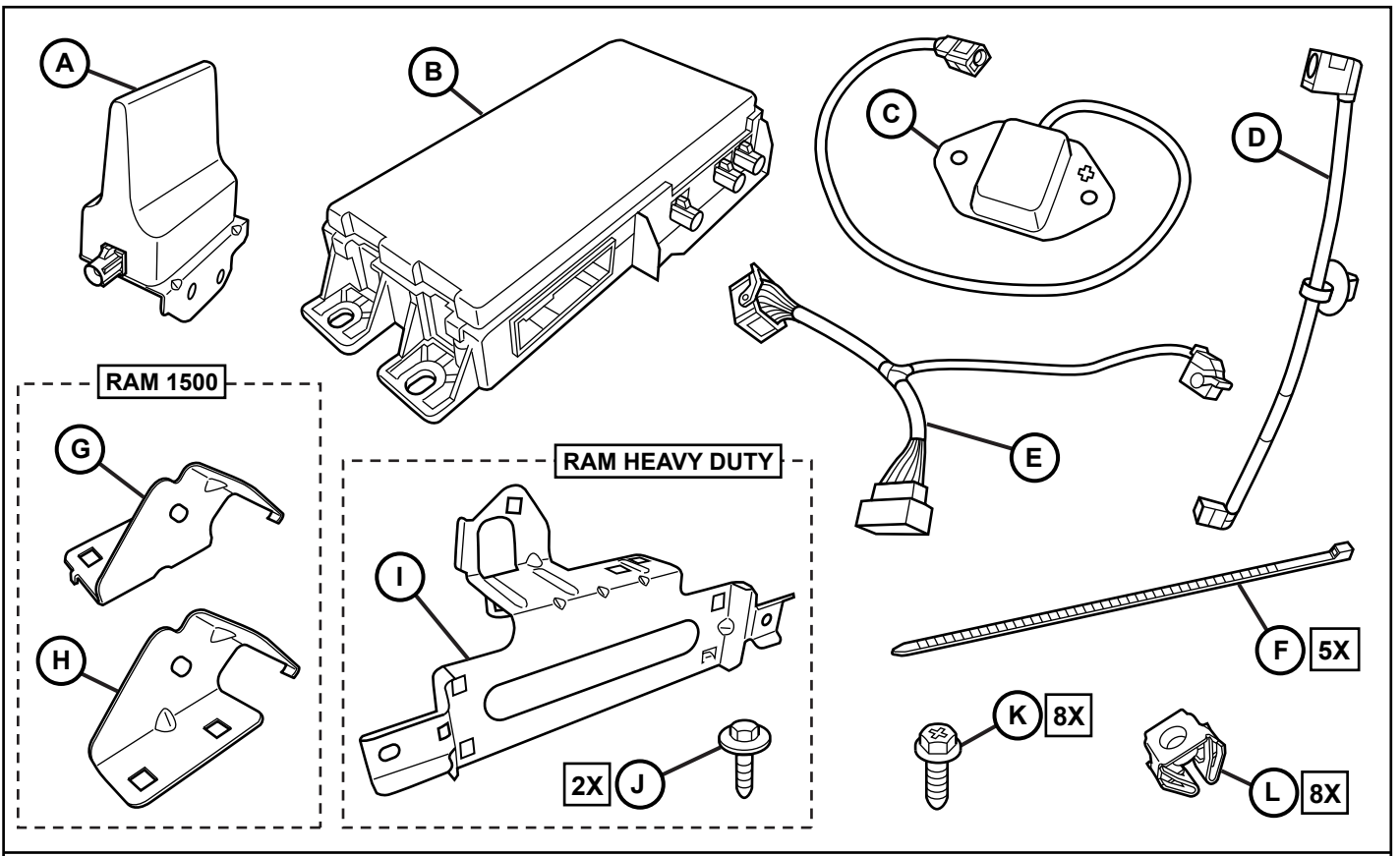

**NOTE: IT IS RECOMMENDED TO READ THE INSTRUCTIONS THOROUGHLY BEFORE INSTALLING THIS ACCESSORY.**

**FOR RAM 1500 FOLLOW PAGES 2 THROUGH 7**

**FOR RAM HEAVY DUTY FOLLOW PAGES 8 THROUGH 13**

**3**

**RETAIN ALL FASTENERS FOR REINSTALLATION**

**4**

**RAM 1500**

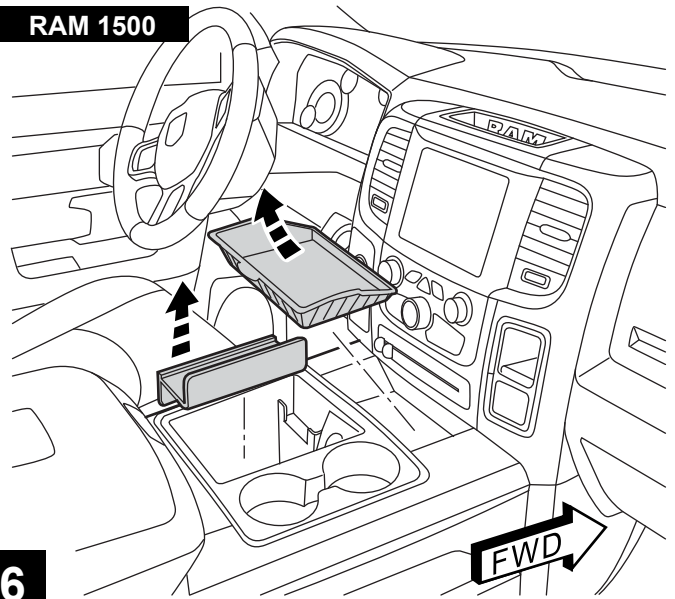

**5**

**6**

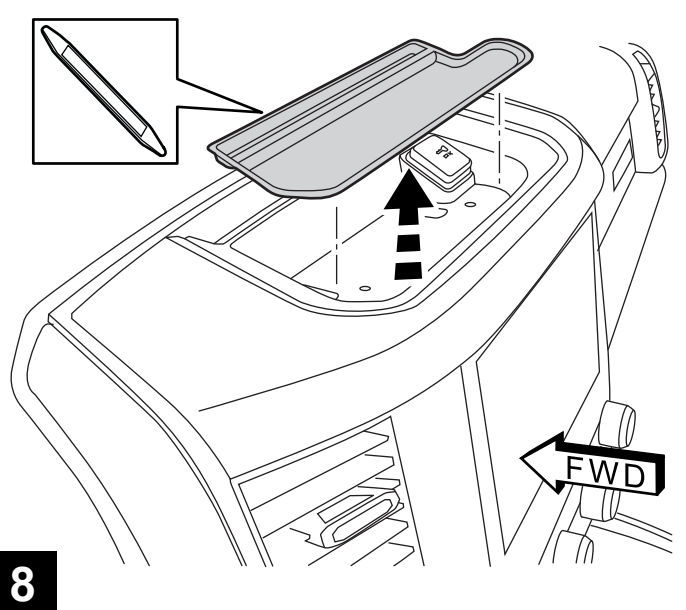
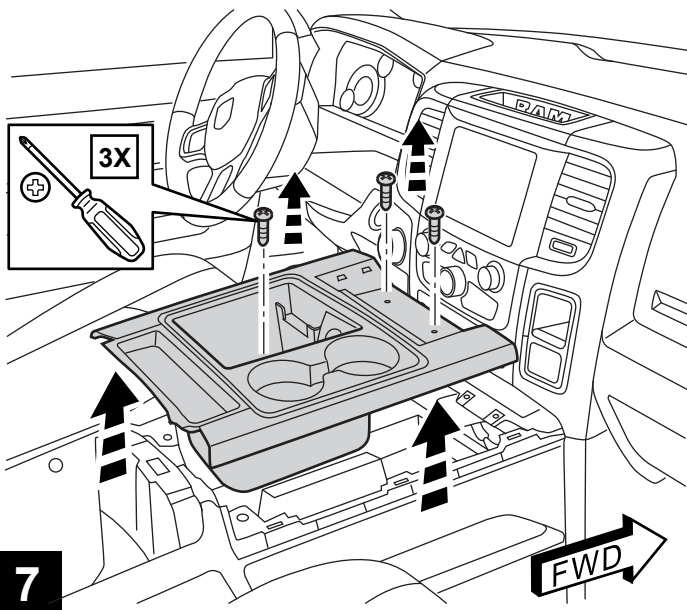

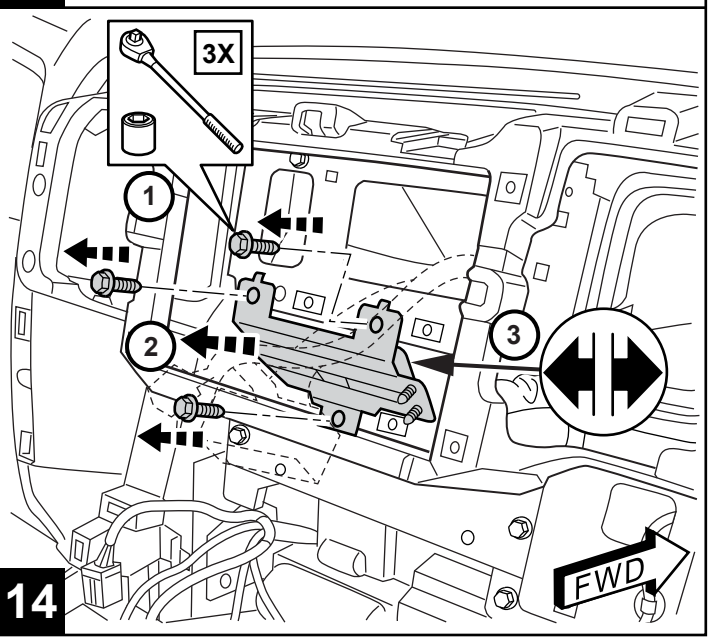
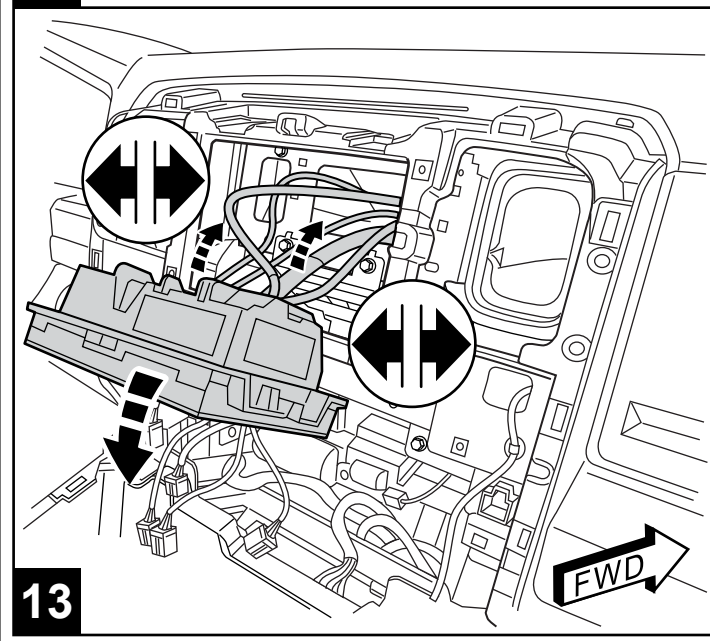
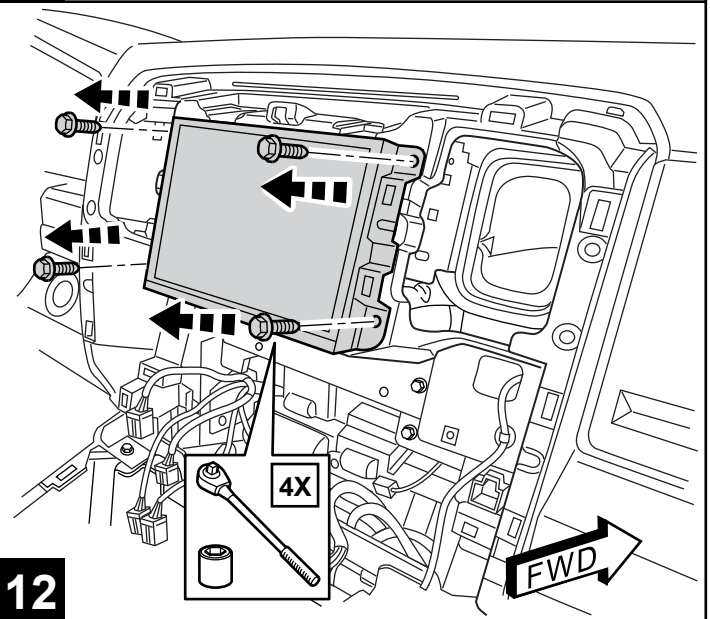
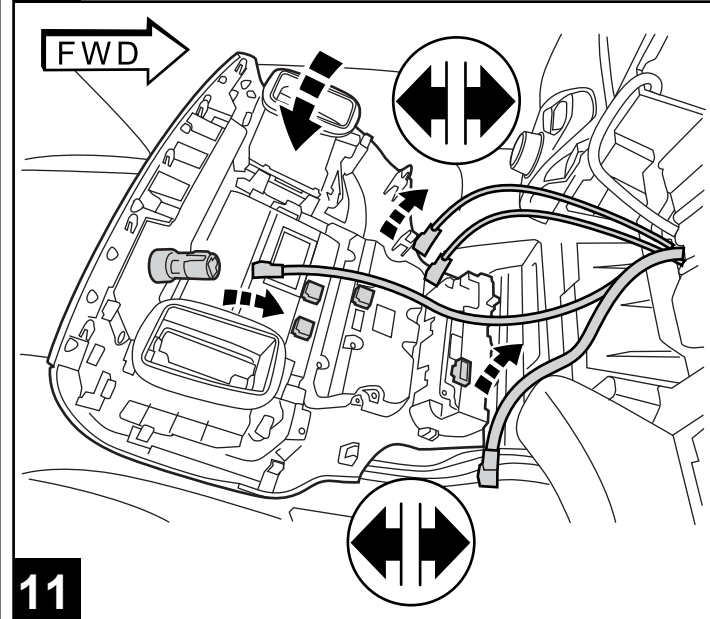
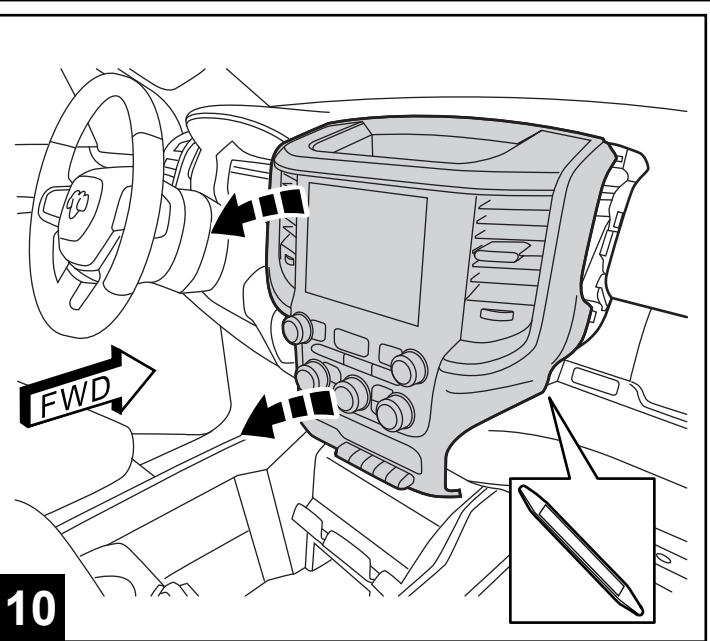
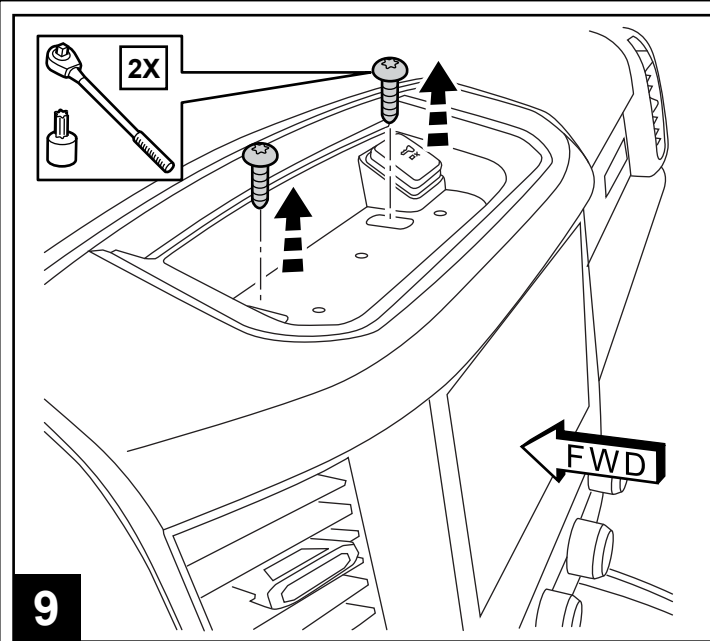

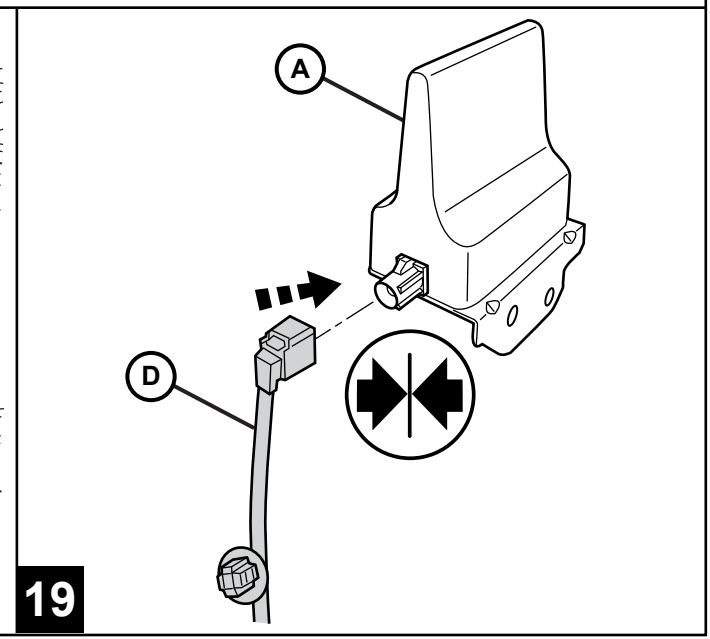
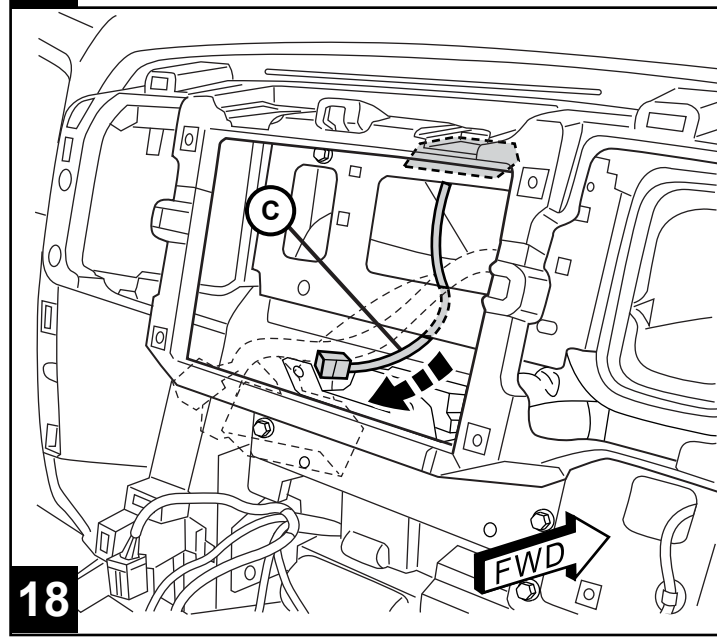
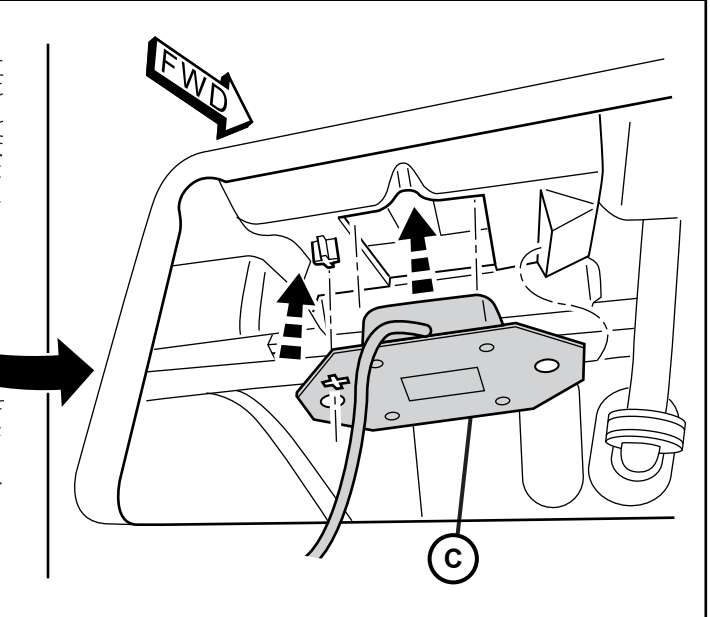
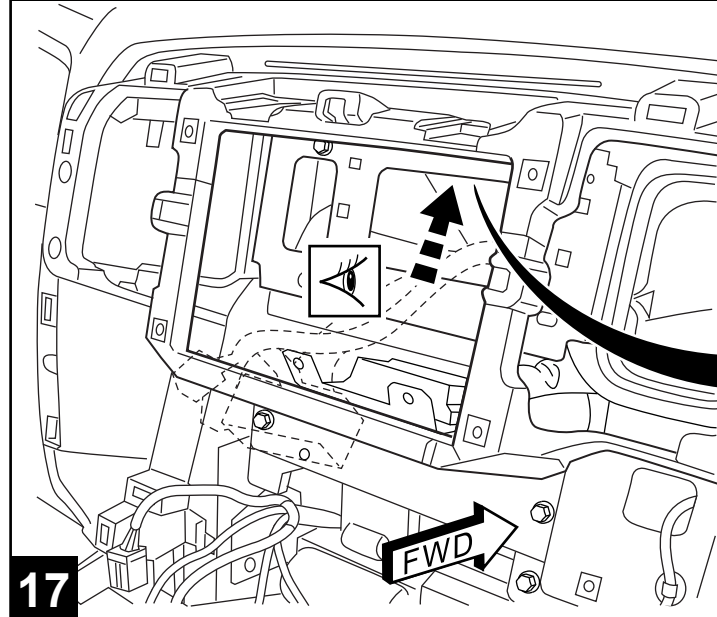
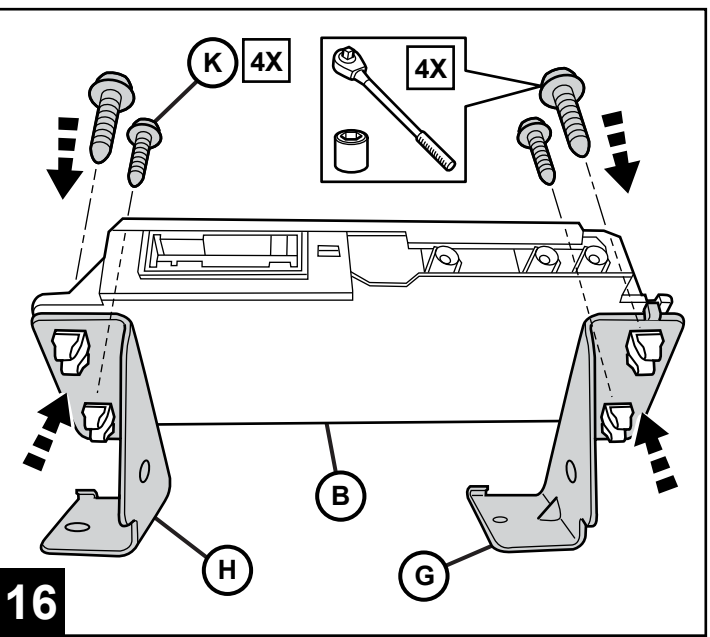
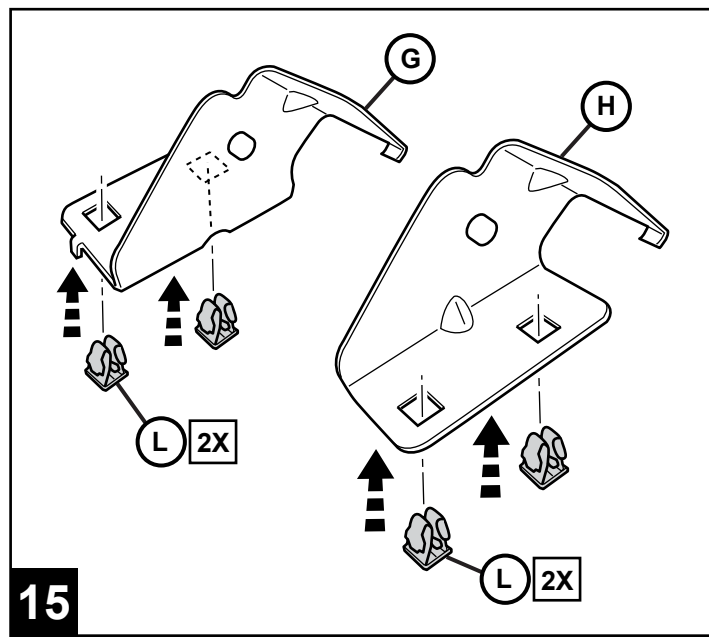



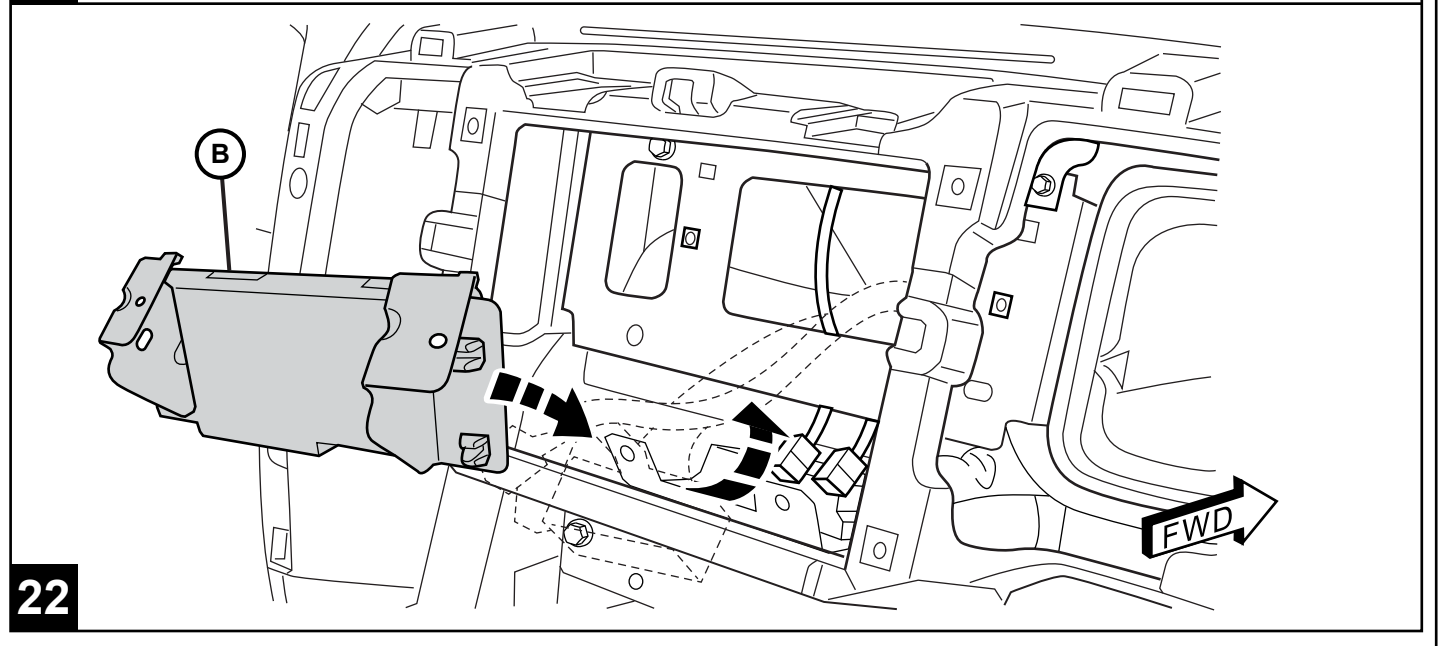
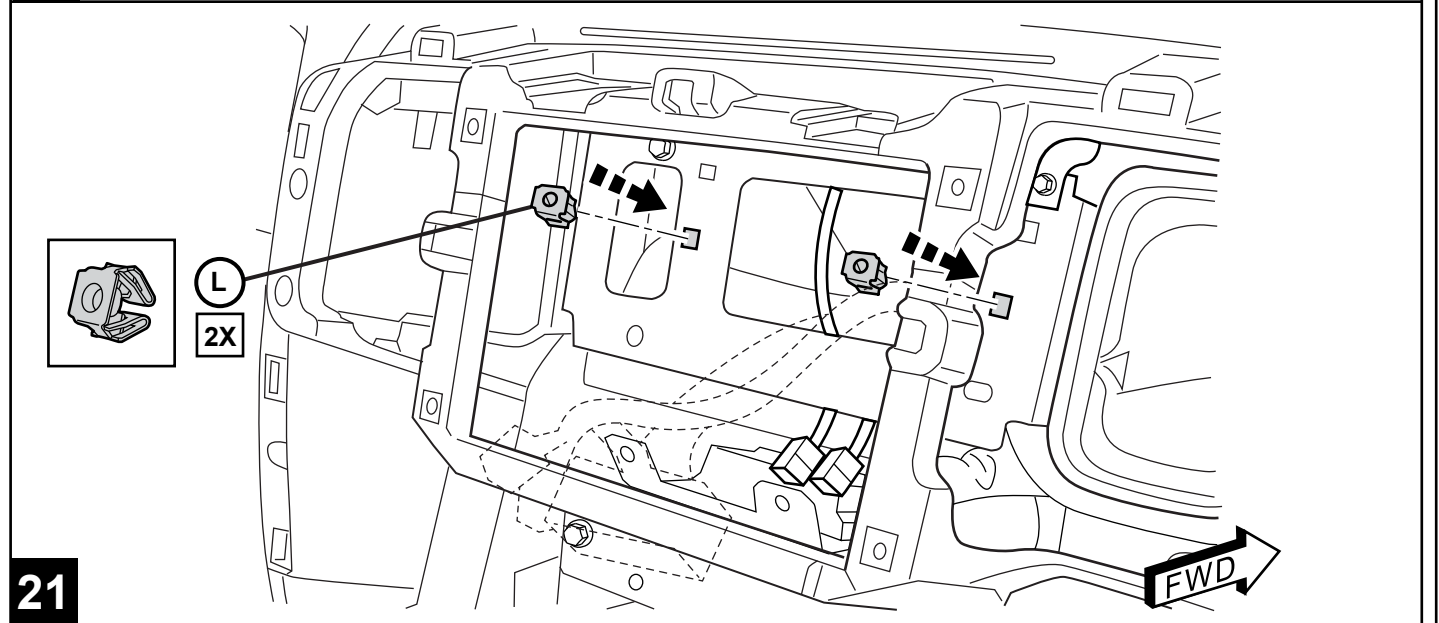
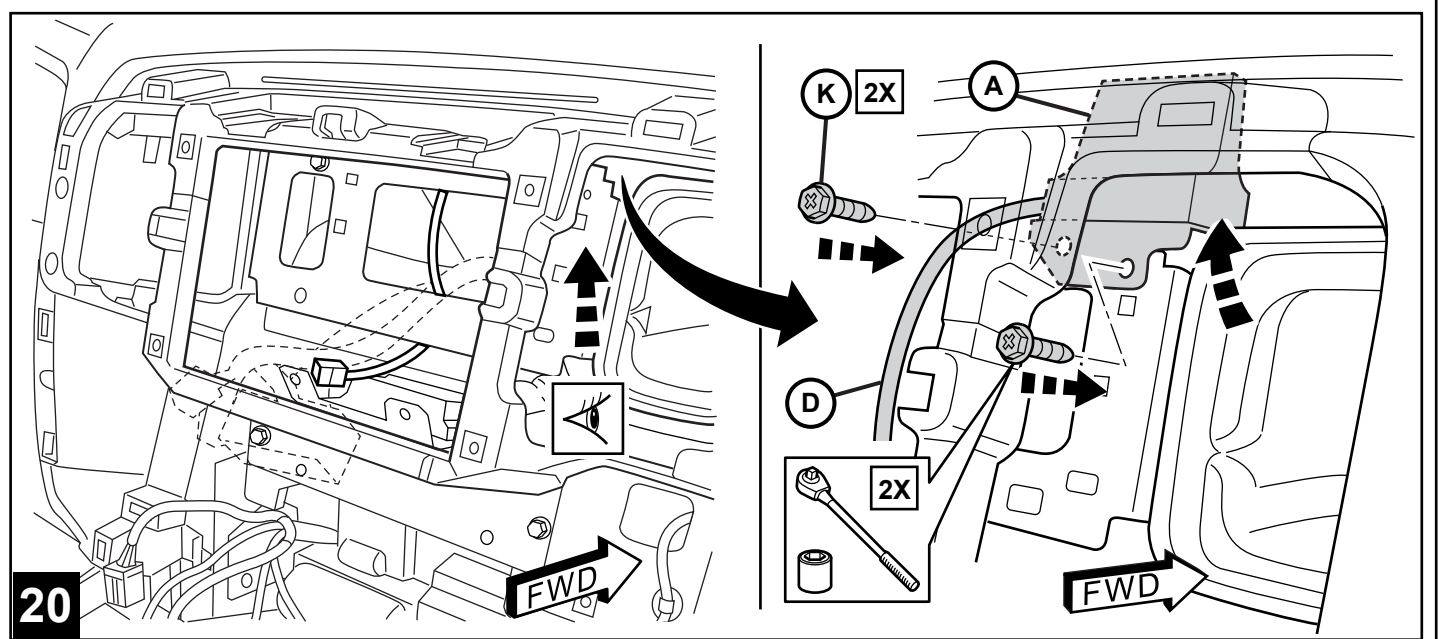

23

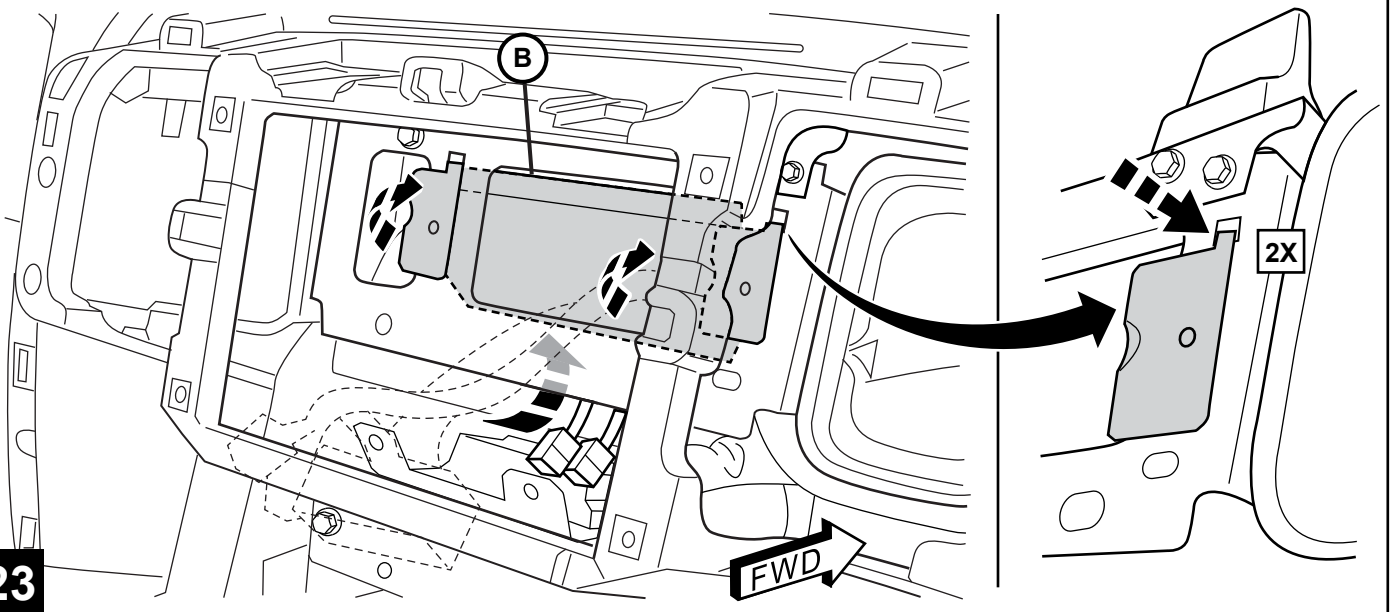

24

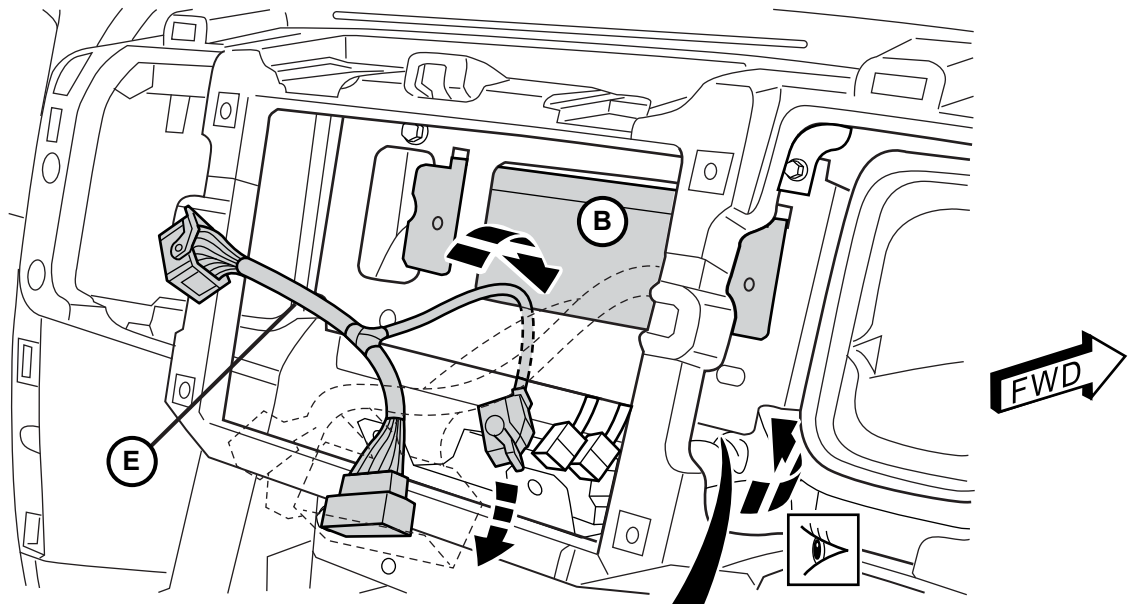

25

VIEW FROM BEHIND  
MODULE (H)

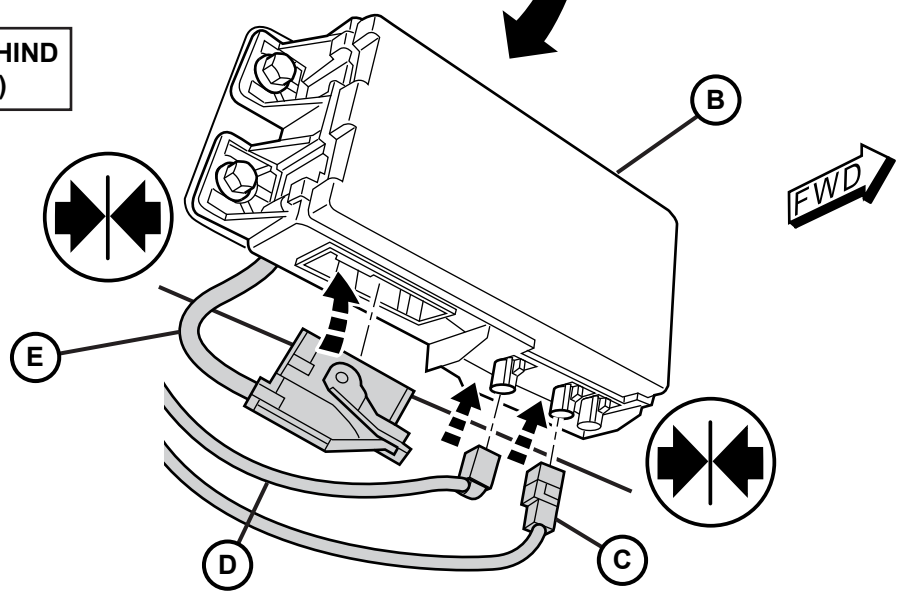

26

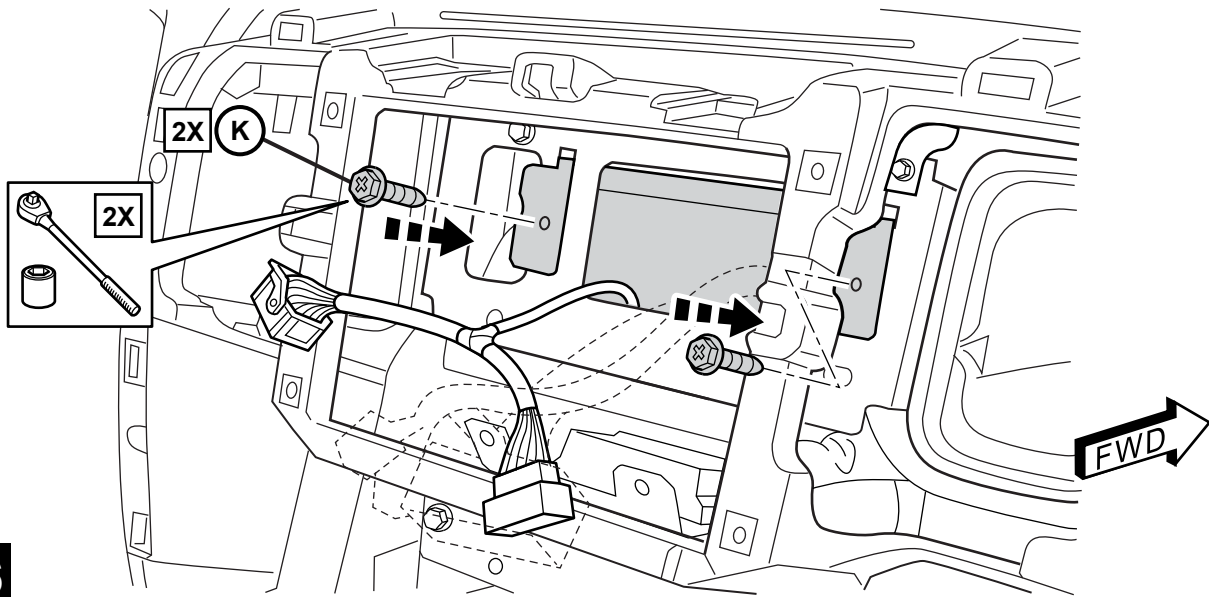

27

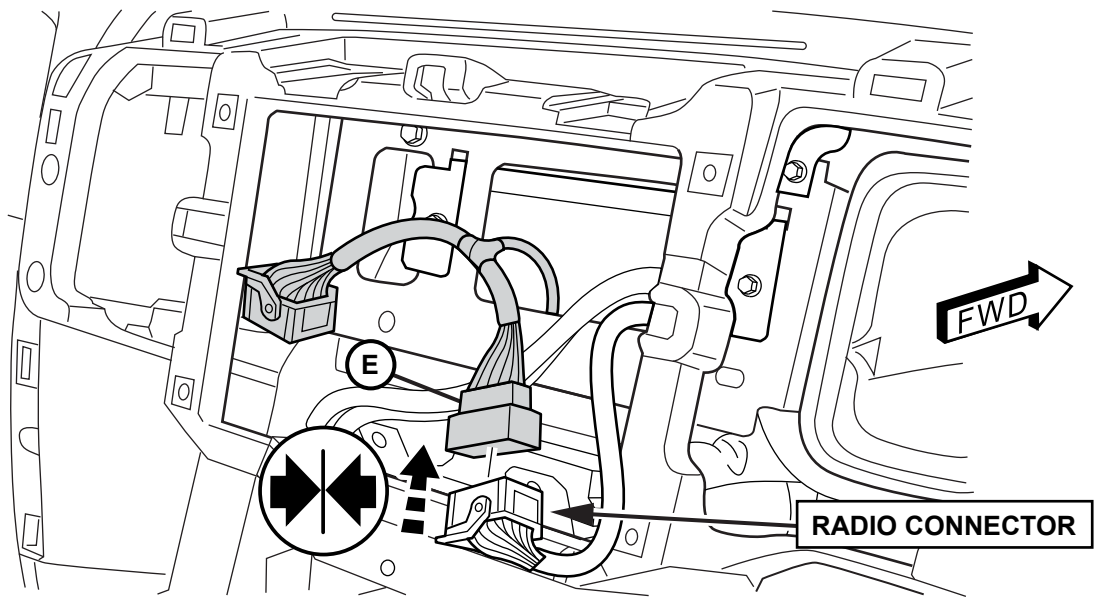

28

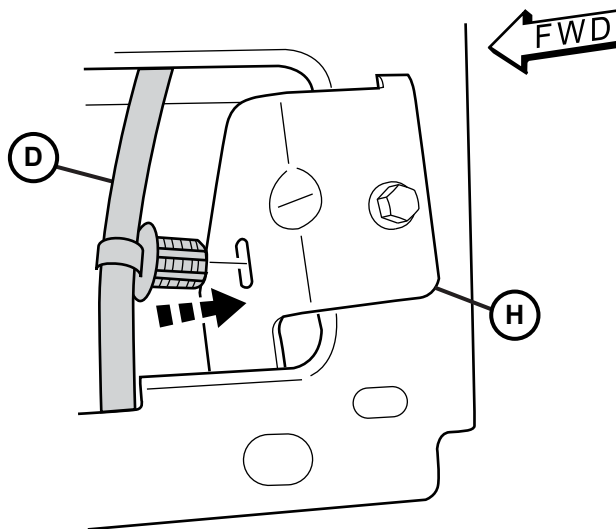

REVERSE STEPS 6 THROUGH 14 TO REINSTALL ALL CONNECTIONS AND INTERIOR COMPONENTS

NOTE: HARNESS (E) WILL NOW CONNECT TO BACK OF RADIO

SECURE ANY EXCESS HARNESS WIRING WITH CABLE TIES (F)

29

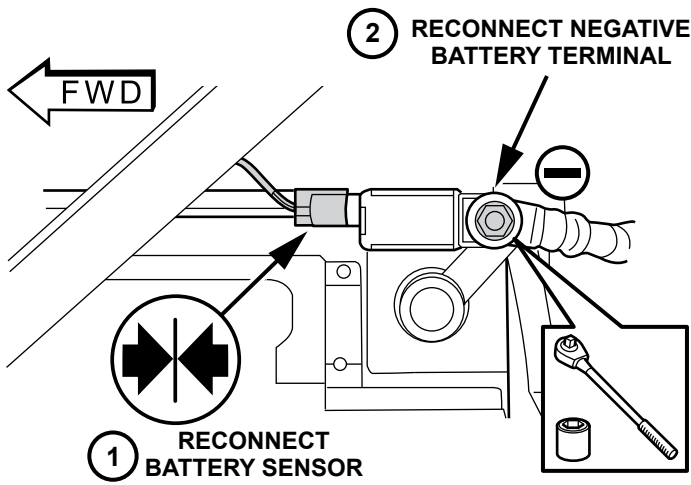

30

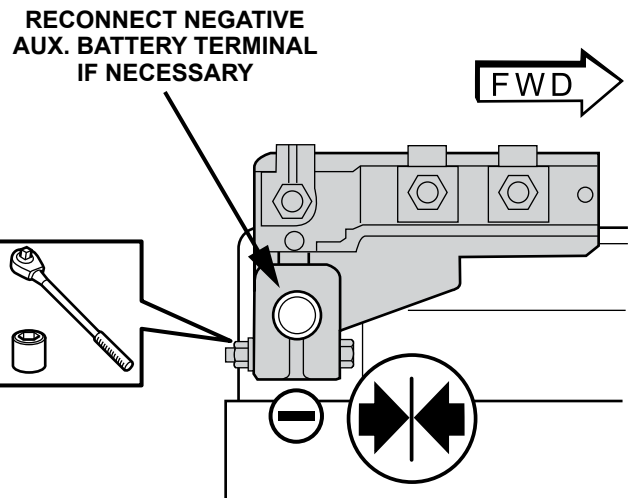

31

PERFORM PROGRAMMING STEPS ON PAGE 15

32



**NOTE: IT IS RECOMMENDED TO READ THE INSTRUCTIONS THOROUGHLY BEFORE INSTALLING THIS ACCESSORY.**

**RETAIN ALL FASTENERS FOR REINSTALLATION**

**HEAVY DUTY**

**1**

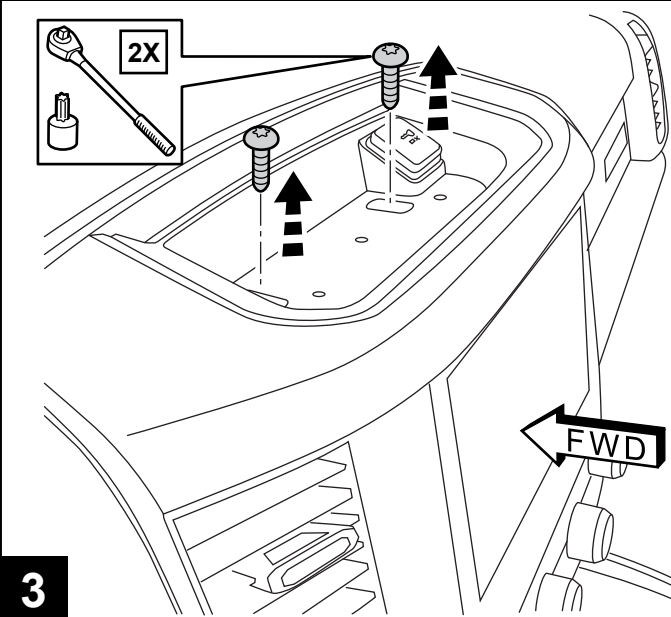

**2**

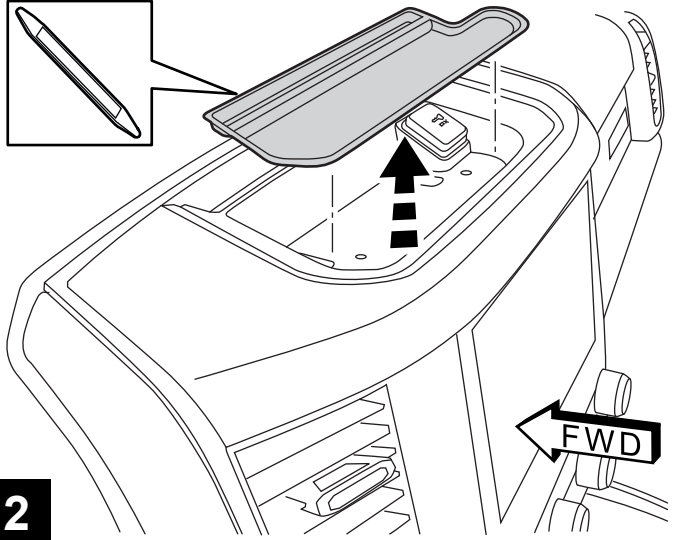

**3**

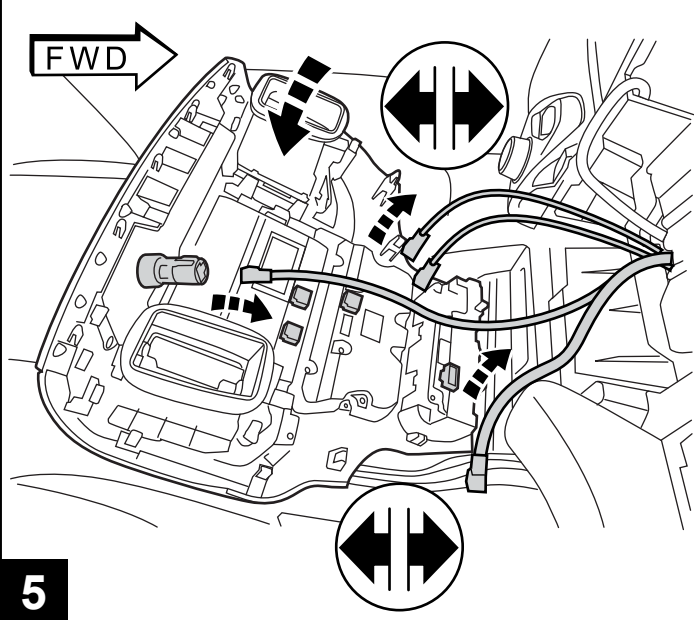

**4**

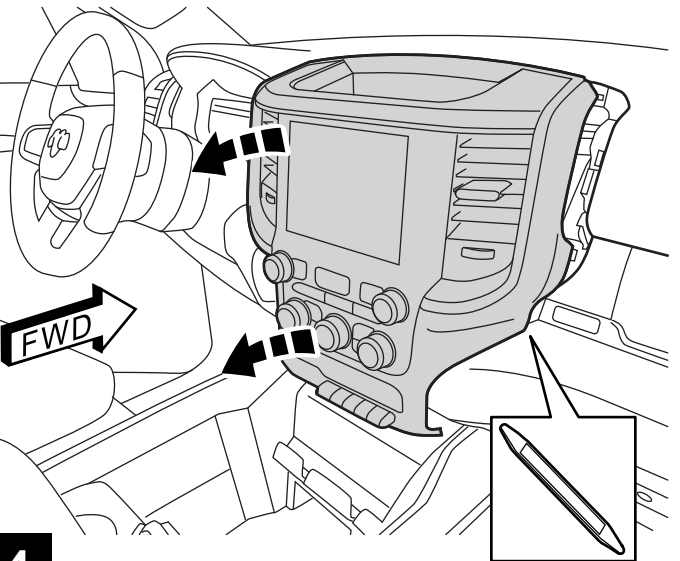

**5**

**6**

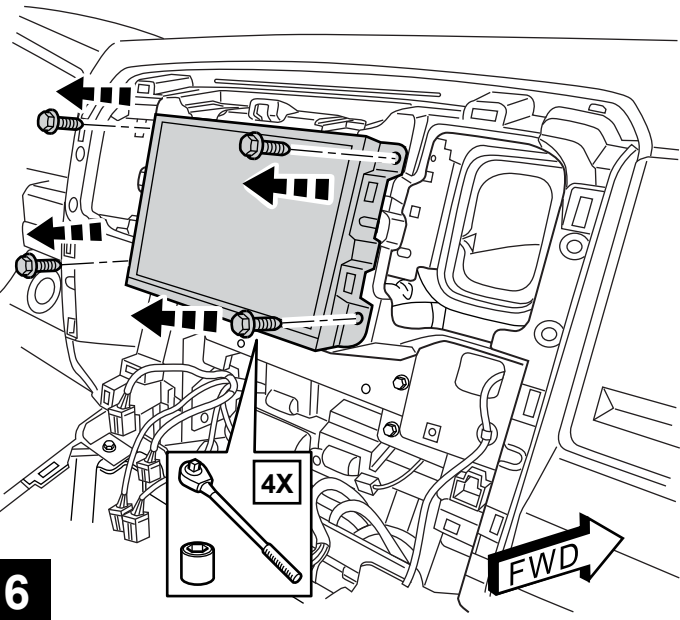

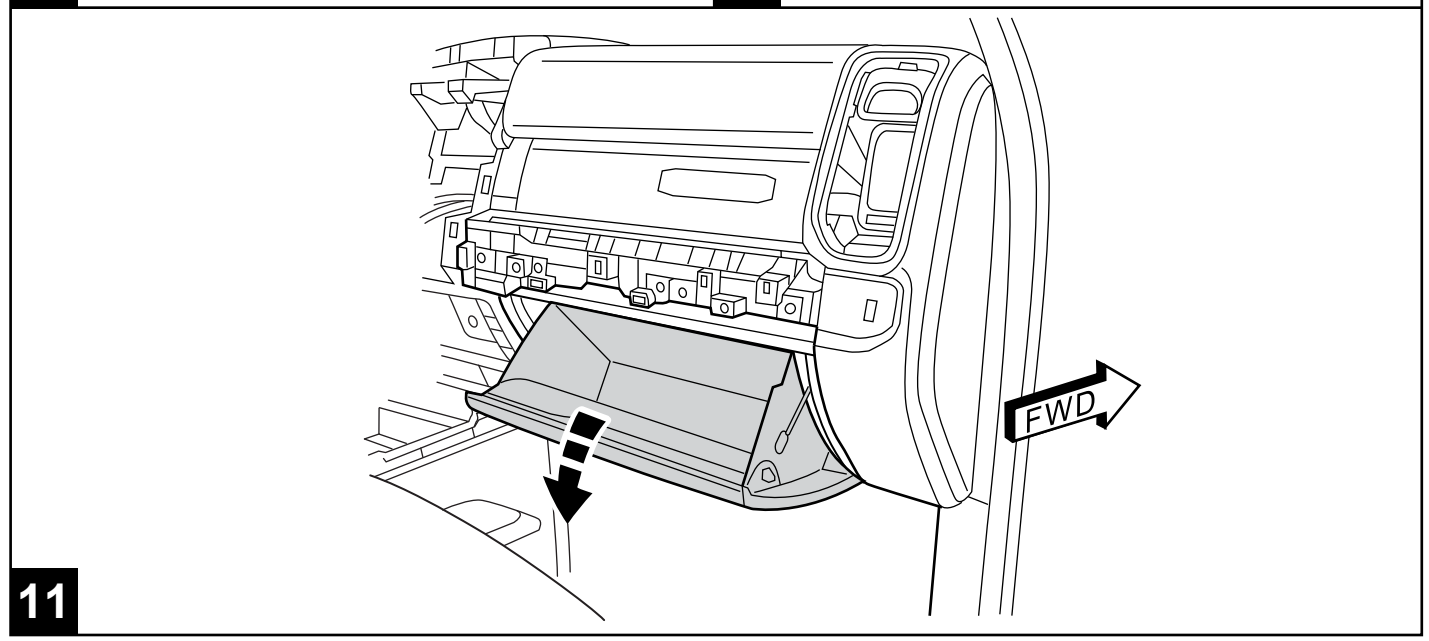
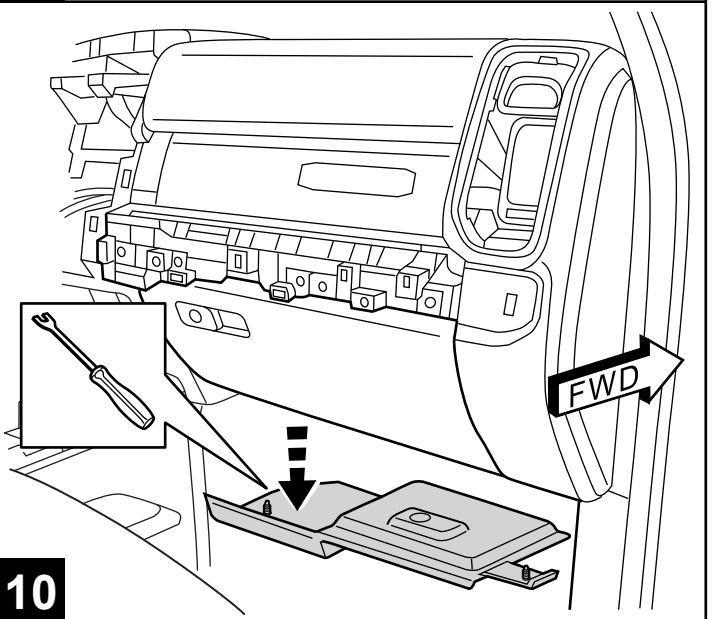
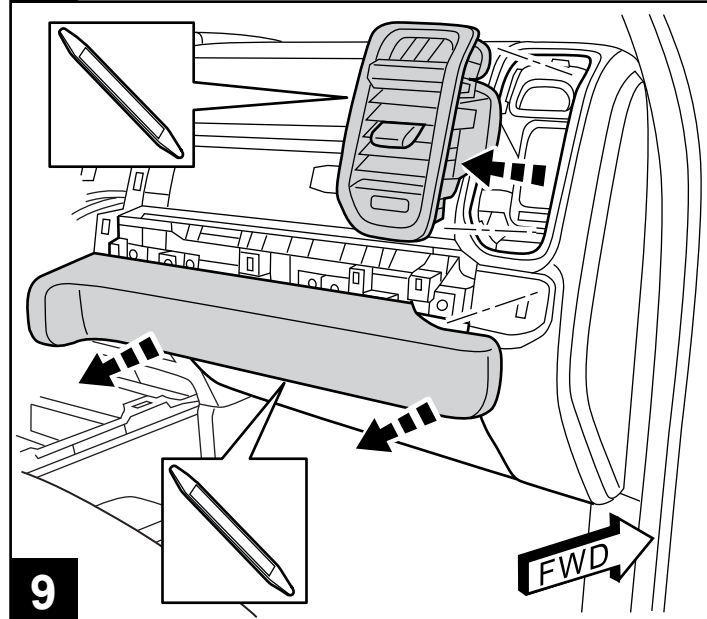
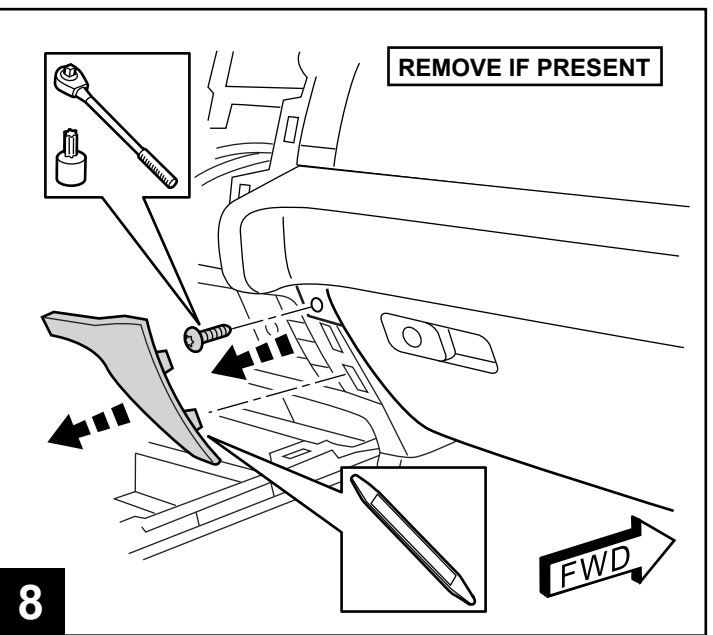
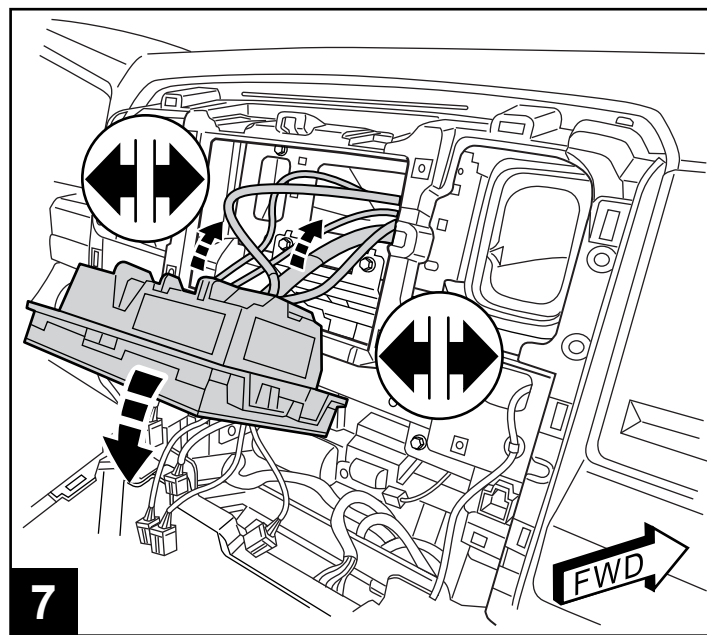

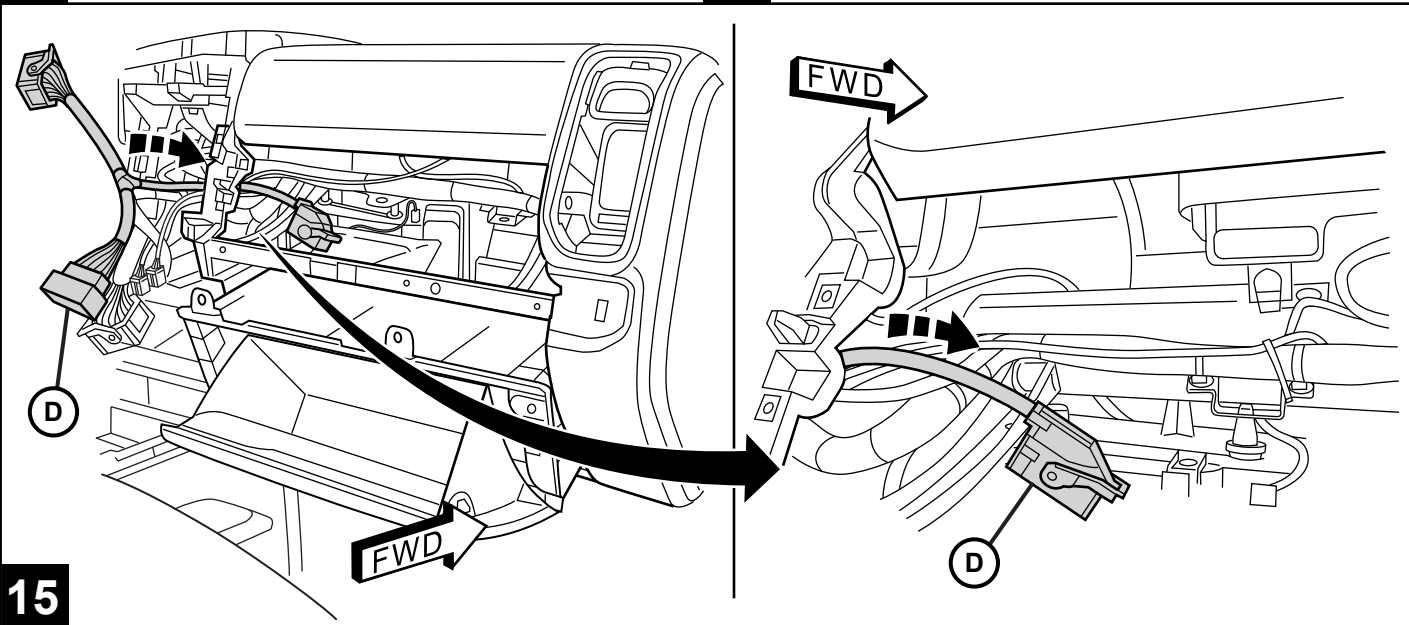
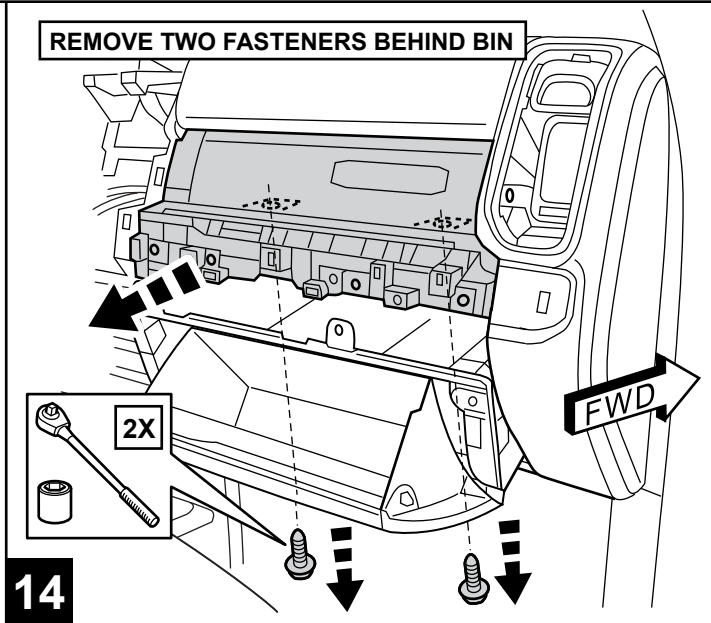
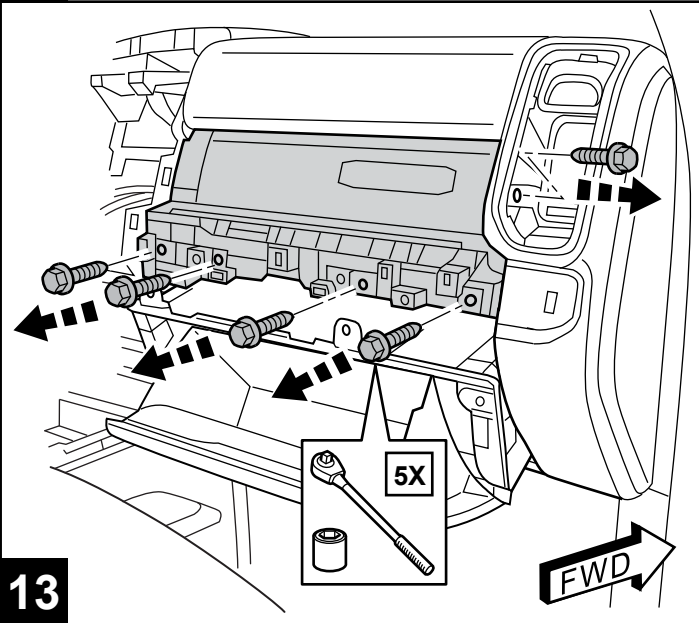
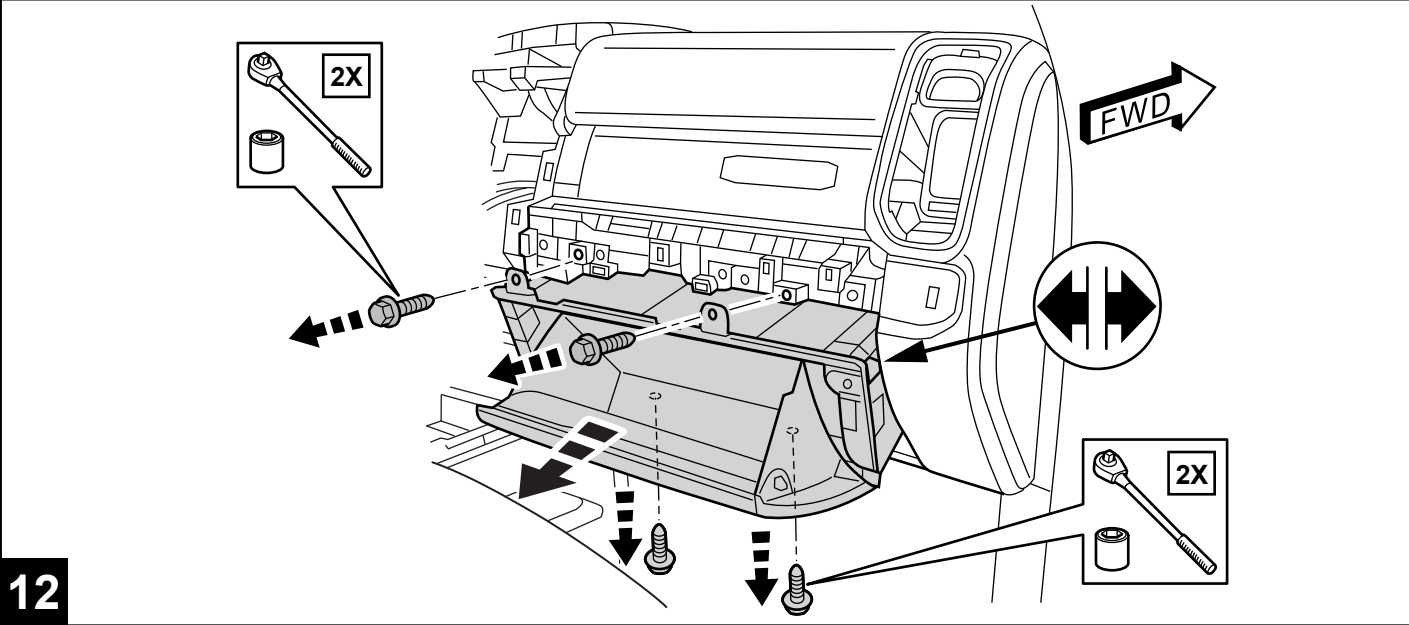

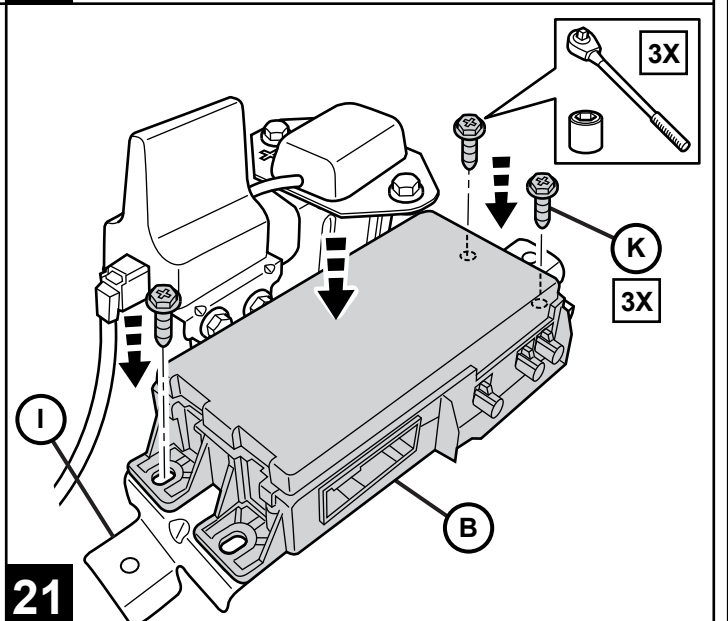
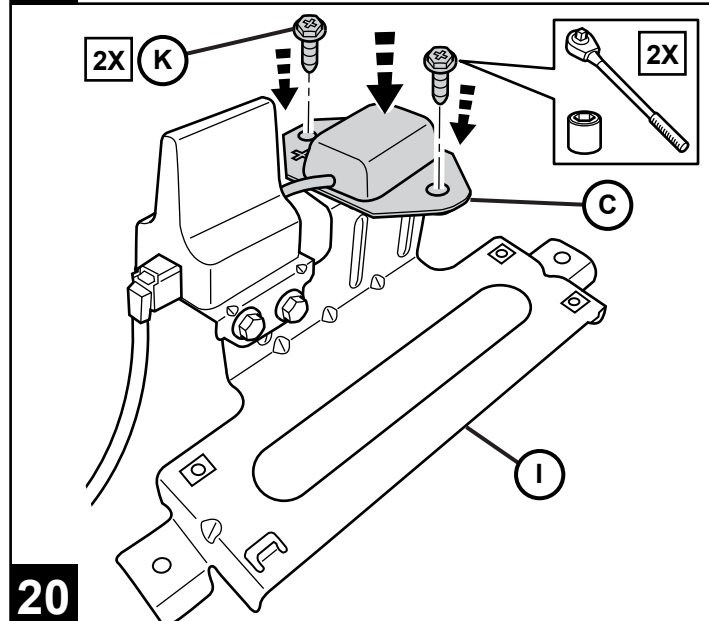
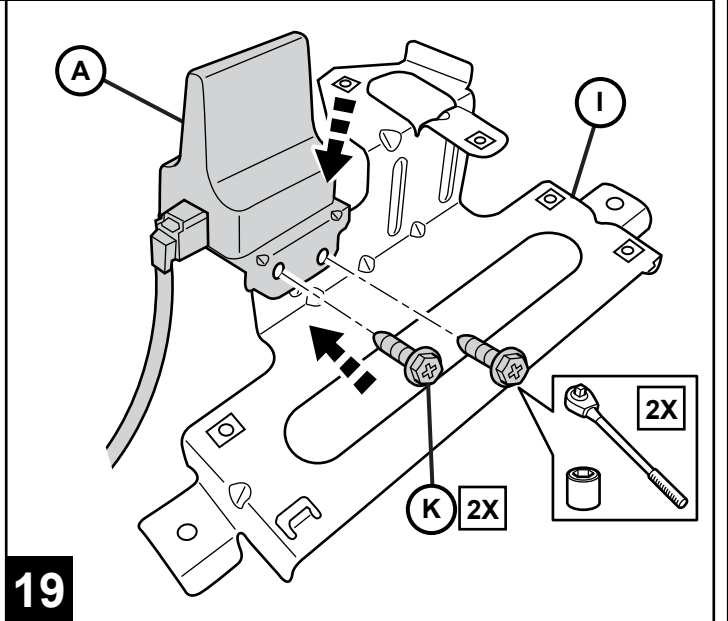
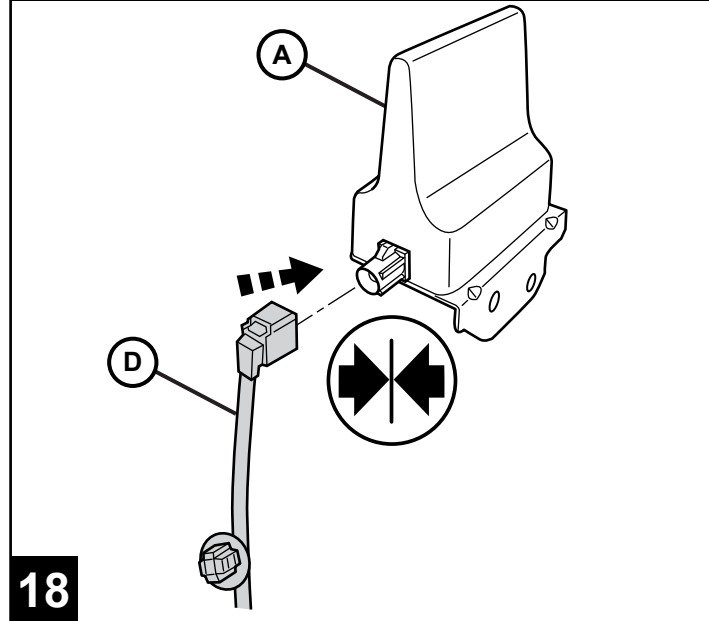
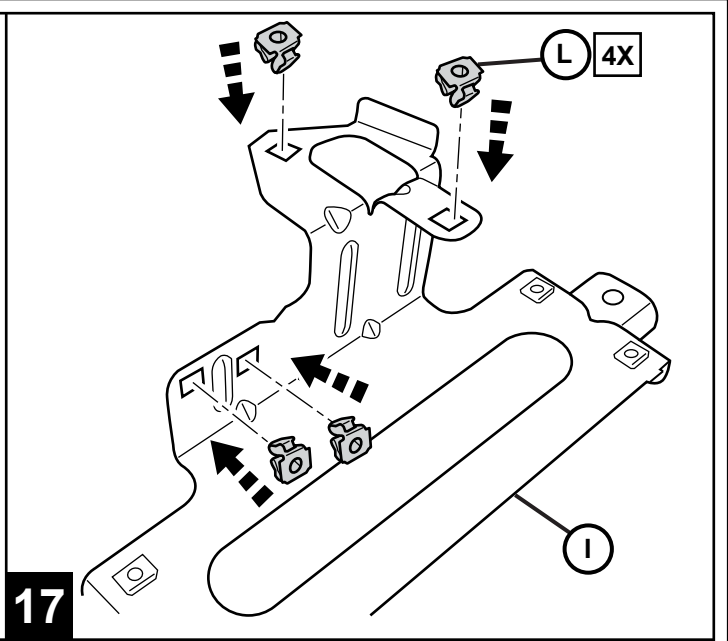
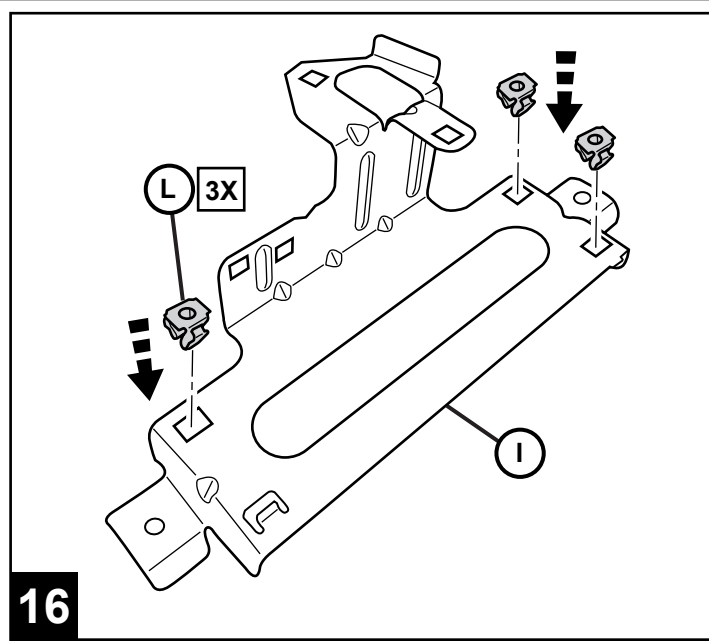



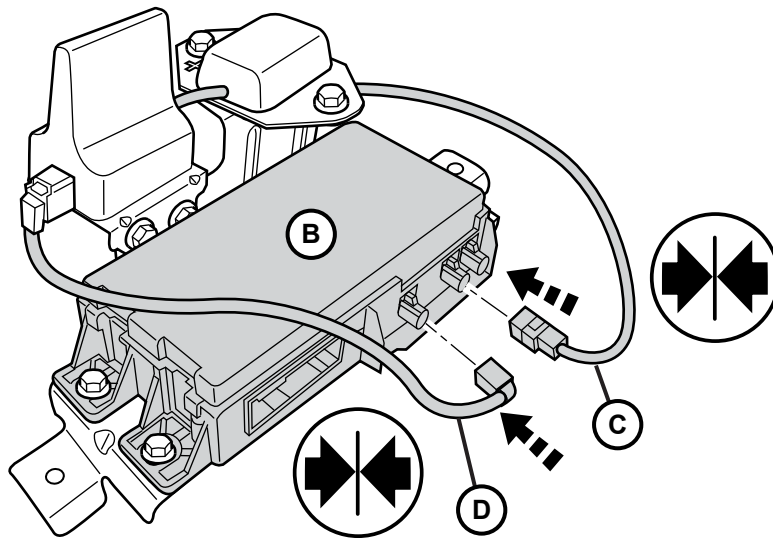

22

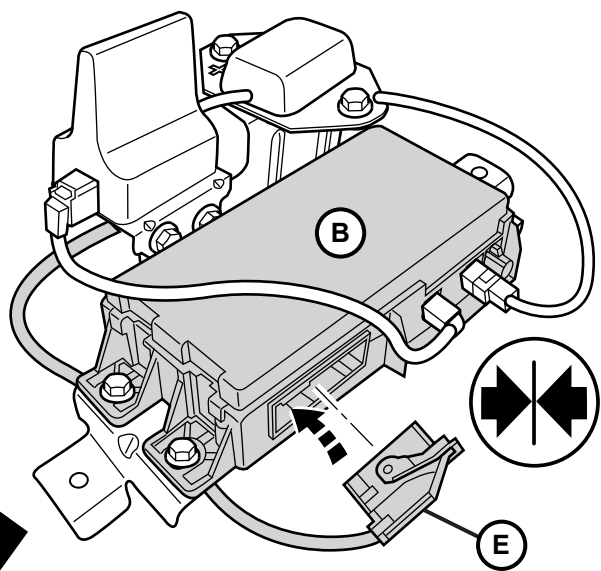
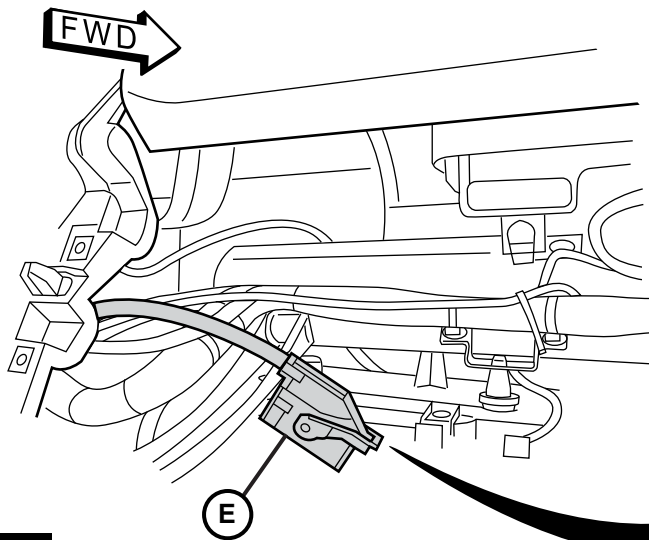

23

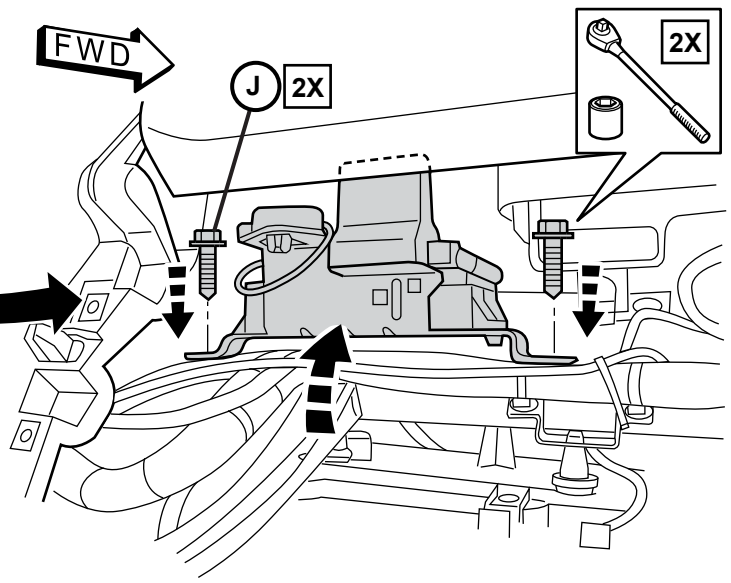
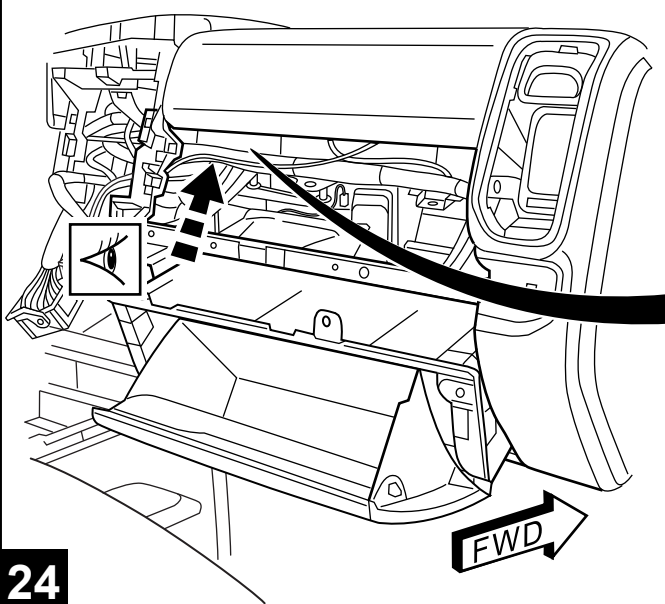

24



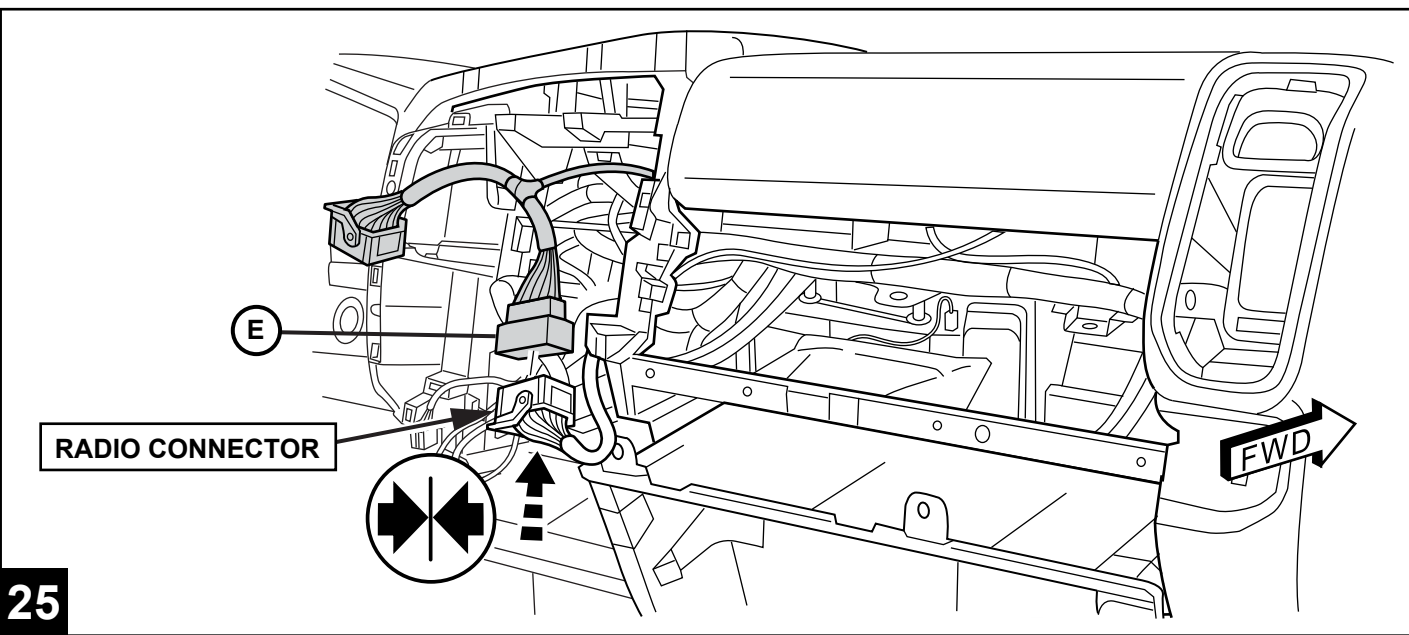

REVERSE STEPS 2 THROUGH 14 TO REINSTALL ALL CONNECTIONS AND INTERIOR COMPONENTS

NOTE: HARNESS (E) WILL NOW CONNECT TO BACK OF RADIO

SECURE ANY EXCESS HARNESS WIRING WITH CABLE TIES (F)

**26**

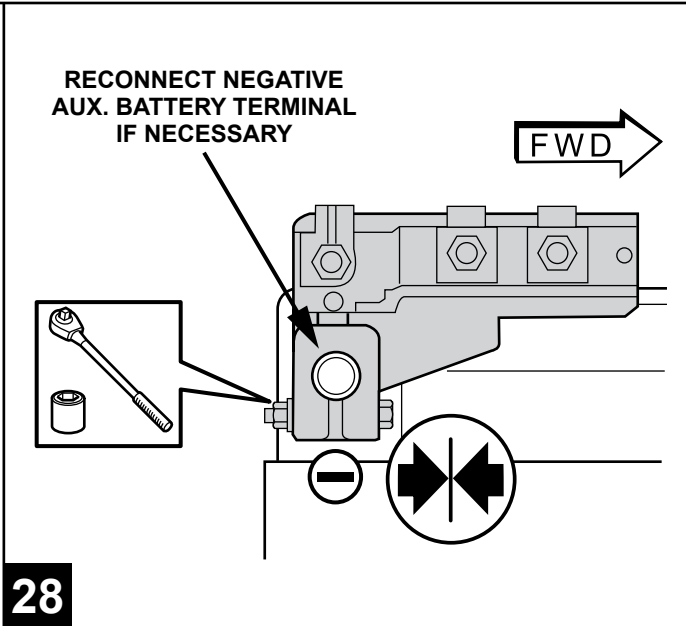
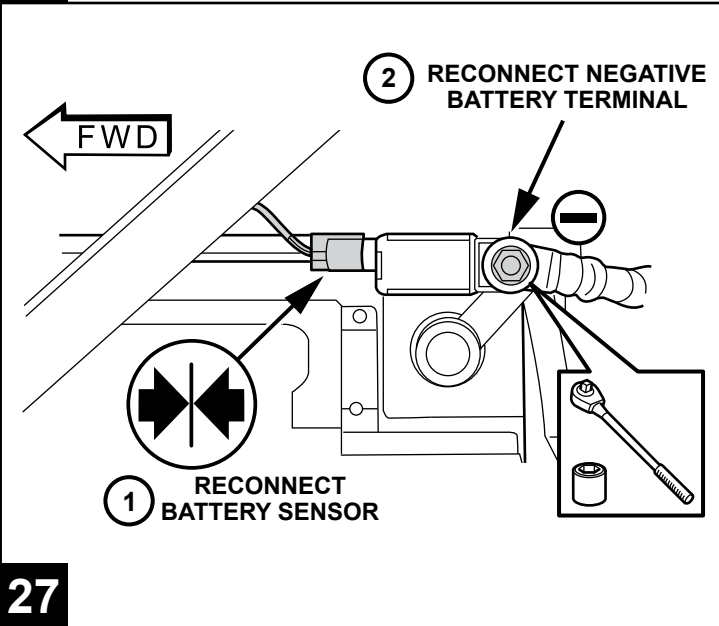

**27**

**28**

PERFORM PROGRAMMING STEPS ON PAGE 15

**29**

**ADD SALES CODE TO VEHICLE IN DealerCONNECT.**

**NOTE: Vehicle VIN must be updated with the sales code of the added accessory in order to enable system functionality. Using the DealerCONNECT website and the scan tool, complete the procedure below:**

1. Log on to <https://dealerconnect.chrysler.com>.
2. In the "Service tab"- "Warranty Administration" box - "Vehicle Option Updates" screen, enter the vehicle VIN and add the sales code RFQ (Ram Telematics) as a "Dealer Installed Option".
3. Confirm that the new sales code has been successfully added to the VIN.

**NOTE: The wiTECH software level must be the latest release to perform this procedure. Check vehicle for fault codes before installation and clear or repair as needed.**

1. With the WiTech tool connected to both the internet and the vehicle, follow the steps below:
2. Place the ignition into the RUN position.
3. Select "Restore Vehicle Configuration" under the Vehicle Preparations menu and follow the WiTech directions.

**CLEAR ALL DTCs**

- a. Cycle ignition to the OFF position
- b. Start the engine and turn the steering lock to lock
- c. Cycle ignition off then cycle to the ON/RUN position (do not start engine)
- d. Check for any DTCs
- e. Clear all DTCs