

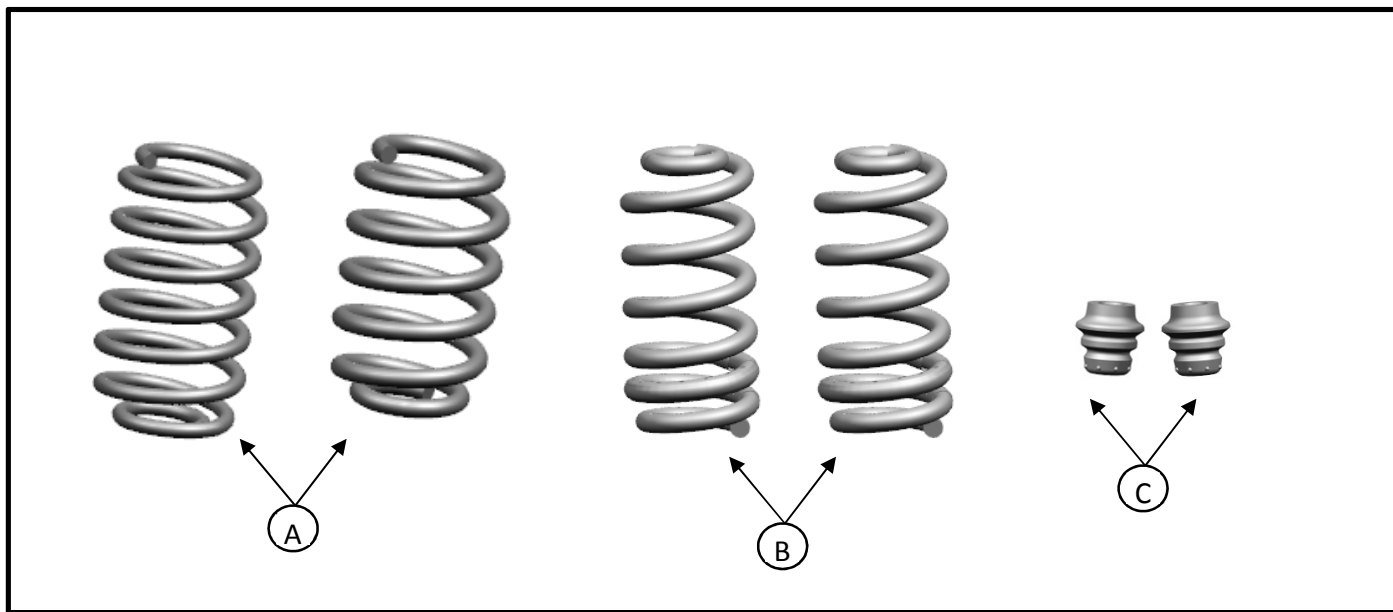

Spring Lowering Kit

Durango SRT

www.mopar.com



ID	Description	Quantity
A	Front Coil Spring	2
B	Rear Coil Spring	2
C	Front Jounce Bumper	2

Instructions, see Service Manual for full details

FRONT

1. Steering Knuckle
2. Upper Control Arms
3. Lower Control Arms
4. Frame Bushings
5. Ball joints
6. Stabilizer Bar Link
7. Stabilizer Bar Retaining Bracket
8. Stabilizer Bar

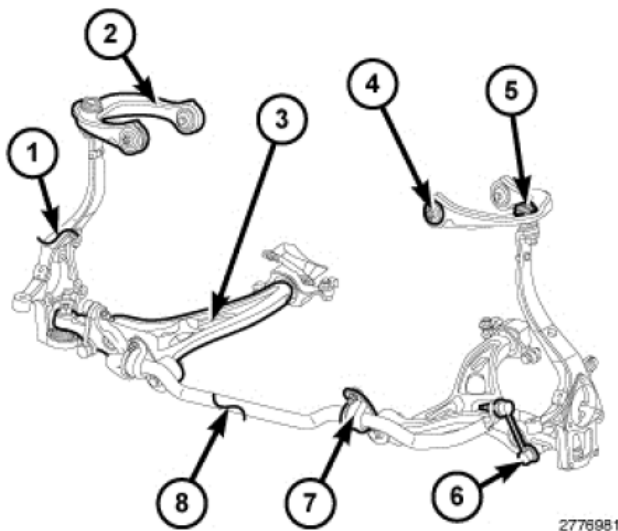

REAR

1. Tension Links
2. Camber Links
3. Coil Spring
4. Shock Absorber
5. Knuckles
6. Stabilizer Bar with Links
7. Lower Control Arm
8. Toe Links

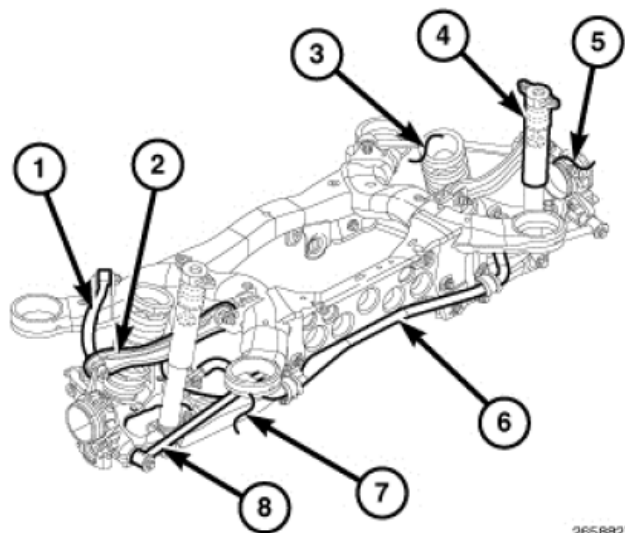

Front

Removal

1. Remove the shock mounting bolts, and shock assembly from vehicle (Reference Service Manual for more details).
2. Using a spring removal/installation tool, disassemble shock assembly to remove the following:
 1. Spring assembly
 2. Upper shock mount
 3. Jounce bumper
 4. Upper spring isolator
 5. Dust shield
 6. Spring

Installation

1. Using a spring removal/installation tool, install lowering kit components in the order which the stock components were removed.
 1. Spring assembly
 2. Upper shock mount
 3. Jounce bumper
 4. Upper spring isolator
 5. Dust shield
 6. Lowering Kit Springs
2. Install the lowering kit shock assembly into the vehicle.

Rear

Removal

1. Remove half shaft nut.
2. Disconnect the following:
 1. Height sensor linkage (if equipped)
 2. Brake Tension Clip
 3. Caliper slide dust bolt shields
 4. Brake caliper from adapter
 5. Tension link to knuckle nut and bolt
 6. Wheel speed sensor bolt and sensor
 7. Camber link to knuckle bolt/nut
 8. Stabilizer link
 9. Shock lower nut/bolt
 10. Toe link knuckle nut and bolt
 11. Half shaft
3. Lower control arm and remove the spring.

Installation

1. Install the new lowering kit springs into cradle.
2. Raise the lower control arm to properly seat spring
3. Install and connect the following. (Torque specifications can be found in Torque Specifications Table)
 1. Half Shaft Nut
 2. Tension Link
 3. Toe Link
 4. Shock Lower Bolt
 5. Stabilizer Link
 6. Camber Link
 7. Wheel Speed Sensor
 8. Caliper Slide Bolt
 9. Caliper Dust Shields
 10. Caliper Tension Clip

Front		
Description	Torque (N-m)	Torque (ft-lb)
Upper Shock Mounting Nuts	28	21
Shock Upper Mounting Nut	50	37
Rear		
Description	Torque (N-m)	Torque (ft-lb)
Half Shaft Nut	310	229
Tension Link Nut	108	79
Toe Link	108	79
Shock Lower Bolt	235	173
Stabilizer Link	110	81
Camber Link to Knuckle Bolt/Nut	110	81
Wheel Speed Sensor Bolt	11	8
Caliper Slide Bolts	27.5	20

It is recommended to have the dealership check and set wheel alignment to production SRT specification after installation is complete.