



2007 CHRYSLER SEBRING TRAILER HITCH

Parts List

ITEM	QTY	PART NUMBER	DESCRIPTION
1	1	1/2"	FISHWIRE TOOL
2	5	600086	NUT, HEX FLANGE, 1/2-13
3	1	600085	BOLT, CARR, 1/2-13x1.5
4	1	600084	SPACER, SQ HOLE 1/4x1x3
5	4	600123	BOLT, HEX, 1/2-13 X 4
6	4	600098	WASHER, FLAT, USS, 1/2"

TOOLS REQUIRED

SOCKET WRENCH

3/4" SOCKET

TORQUE WRENCH

FISHWIRE TECHNIQUE

INSERT COILED END OF FISHWIRE TOOL THROUGH HITCH MOUNTING HOLE IN VEHICLE FRAME RAIL AND OUT THE ACCESS HOLE. PASS COILED END OF FISHWIRE THROUGH SPACER AND THREAD BOLT INTO COIL. KINK WIRE TO KEEP SPACER SEPARATE FROM BOLT AS SHOWN. PULL FISHWIRE, SPACER, AND BOLT THROUGH FRAME AND OUT MOUNTING HOLE. USE FISHWIRE TO GUIDE HITCH DURING MOUNTING AND PREVENT LOSS OF BOLT / SPACER INSIDE FRAME RAIL.

***NOTE: SOME VEHICLES MAY FISHWIRE THROUGH END OF FRAME**

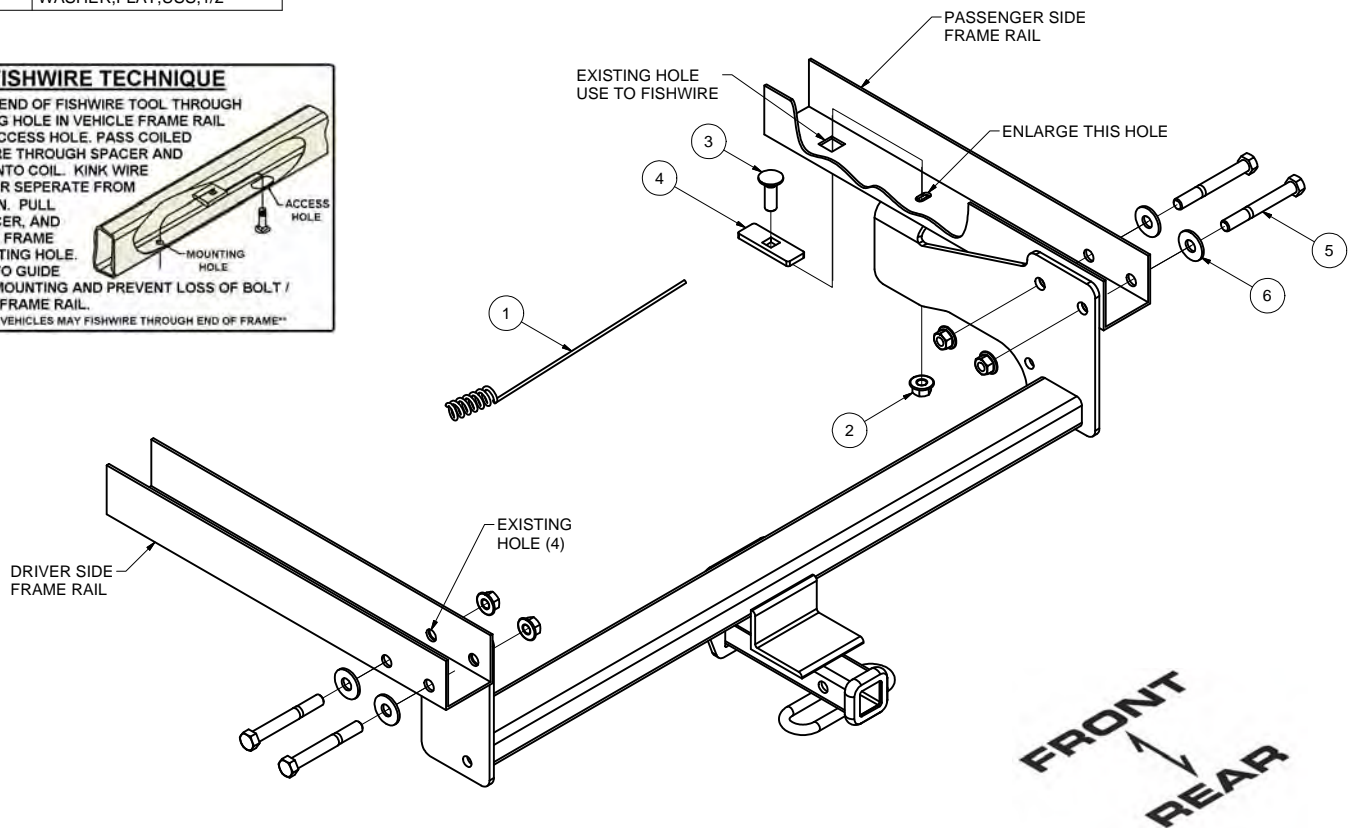

INSTALLATION INSTRUCTIONS:

- 1) Raise hitch into position between frame rails as shown. Push exhaust to side or lower if needed.
- 2) Install the four 1/2"-13 x 4" hex bolts with 1/2" washers from the outside of frames as shown. Fasten with 1/2" flange nuts finger tight to the sideplates.
- 3) With hitch in position, enlarge hole in frame at the flange of the passenger side plate with a 17/32" drill bit to fit a 1/2" bolt. It is advised to paint any exposed metal after drilling.
- 4) Fishwire 1/2"-13 x 1 1/2" carriage bolt with square hole spacer through existing square hole in frame to the enlarged hole and fasten to side plate with 1/2" flange nut. Finger tight only.
- 5) With all fasteners in place, torque all 1/2" hardware to 110 ft.-lb (149 N•m).